

DA Mirvac - Att 1 Proposed Staging Plan

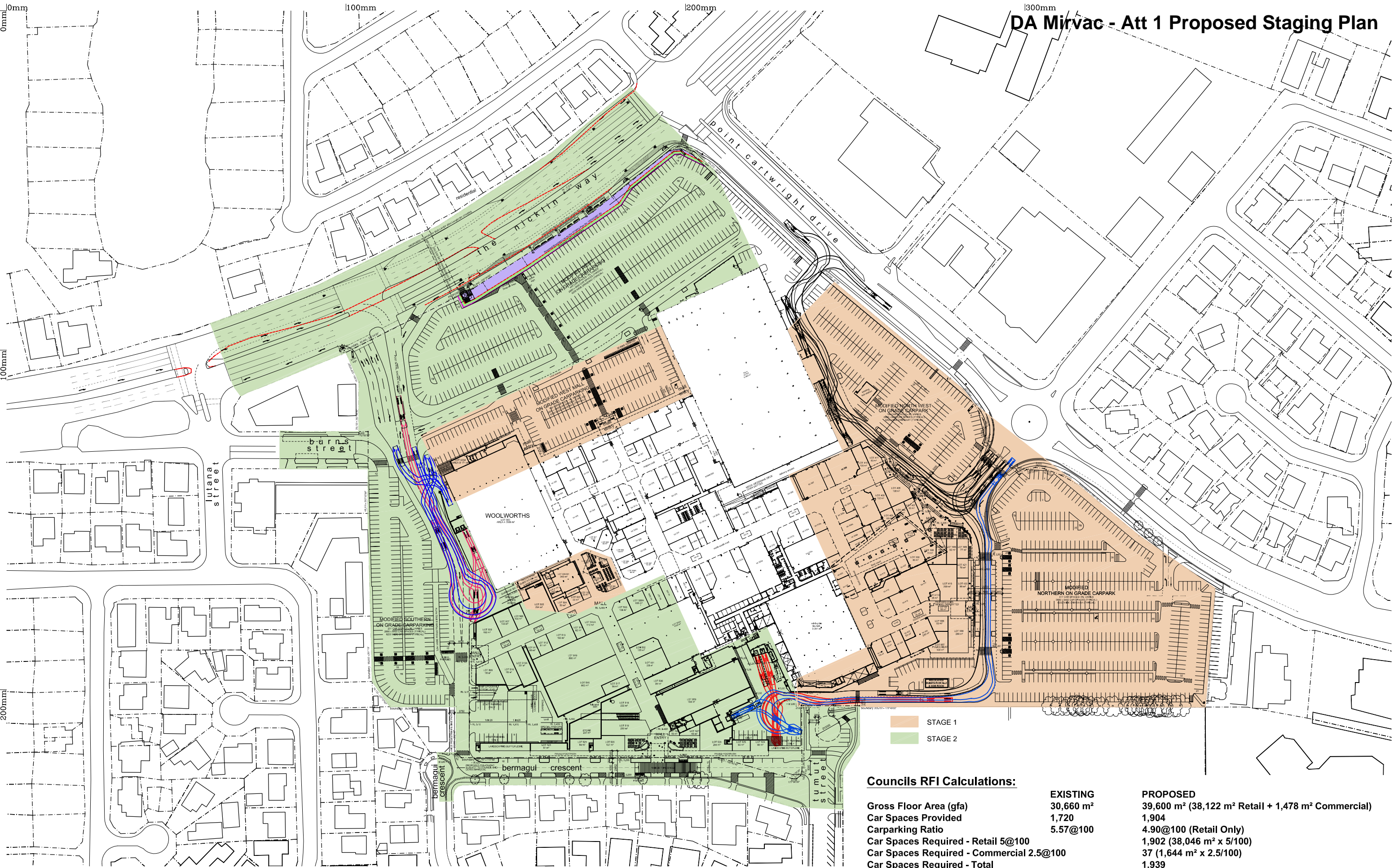

Councils RFI Calculations:

	EXISTING	PROPOSED
Gross Floor Area (gfa)	30,660 m ²	39,600 m ² (38,122 m ² Retail + 1,478 m ² Commercial)
Car Spaces Provided	1,720	1,904
Carparking Ratio	5.57@100	4.90@100 (Retail Only)
Car Spaces Required - Retail 5@100		1,902 (38,046 m ² x 5/100)
Car Spaces Required - Commercial 2.5@100		37 (1,644 m ² x 2.5/100)
Car Spaces Required - Total		1,939
Bike Parking		79 Public Parking + 20 Staff Parking

rev:	date:	amendment:
A	16.02.11	ISSUED FOR CONCURRENCE AGENCY'S RESPONSE.
B	26.07.11	ROAD WORKS & CARPARK REVISED AS PER TTM.
C	19.08.11	ROAD WORKS & CARPARK REVISED.
D	20.08.11	CALCULATION & NOTE TO CUL-DE-SAC ADDED.
		LOT 529 LOADING DOCK REVISED.

NOTE:
Red lines shown on the drawings are existing kerb line & existing pedestrian crossing, etc.



project:
KAWANA SHOPPINGWORLD QUEENSLAND
Copyright of the design and other information shown here is owned by Mircac Design Pty. Ltd. Reproduction or use of the design by any party for any purpose is expressly forbidden without the written permission of Mircac Design Pty. Ltd.

architect:
MIRVAC DESIGN
architects
planners
interior designers
Level 26, 60 Margaret St.
Sydney, NSW 2000
tel. 02 9080 8000
fax. 02 9080 8181
Mircac Design Pty. Ltd.
ABN 78 003 359 153



title:
Proposed CoastConnect
The Nicklin Way
Site and Floor Plan

drawn:
approved:
job no: 4.472
lot no:
date: FEBRUARY 2011
drawing no: RFI_CC_1
scale @ A3: 1:2000
rev: D