

TELECOMMUNICATIONS SERVICE PROVIDERS



NOTE: SERVICE LOCATIONS ARE APPROXIMATE ONLY FROM PROVIDERS PLANS. LOCATIONS ARE TO BE CONFIRMED PRIOR TO START OF CONSTRUCTION. PHONE DBYD SERVICE LOCATIONS ON 1100 FOR DETAILS.

ENERGY SERVICE PROVIDERS



NOTE: SERVICE LOCATIONS ARE APPROXIMATE ONLY FROM PROVIDERS PLANS. LOCATIONS ARE TO BE CONFIRMED PRIOR TO START OF CONSTRUCTION. PHONE DBYD SERVICE LOCATIONS ON 1100 FOR DETAILS.

DIAL BEFORE YOU DIG

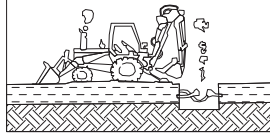

PSM No: 132196
(AHD)RL: RL 13.006
SURVEYED: D. Black

SCHOLARS DRIVE
UNIVERSITY OF THE SUNSHINE COAST
BUS LINK FACILITY.

SERVICE LOCATIONS

It is the responsibility of the Foreman to contact the relevant service authorities to ascertain the exact location of services prior to construction.

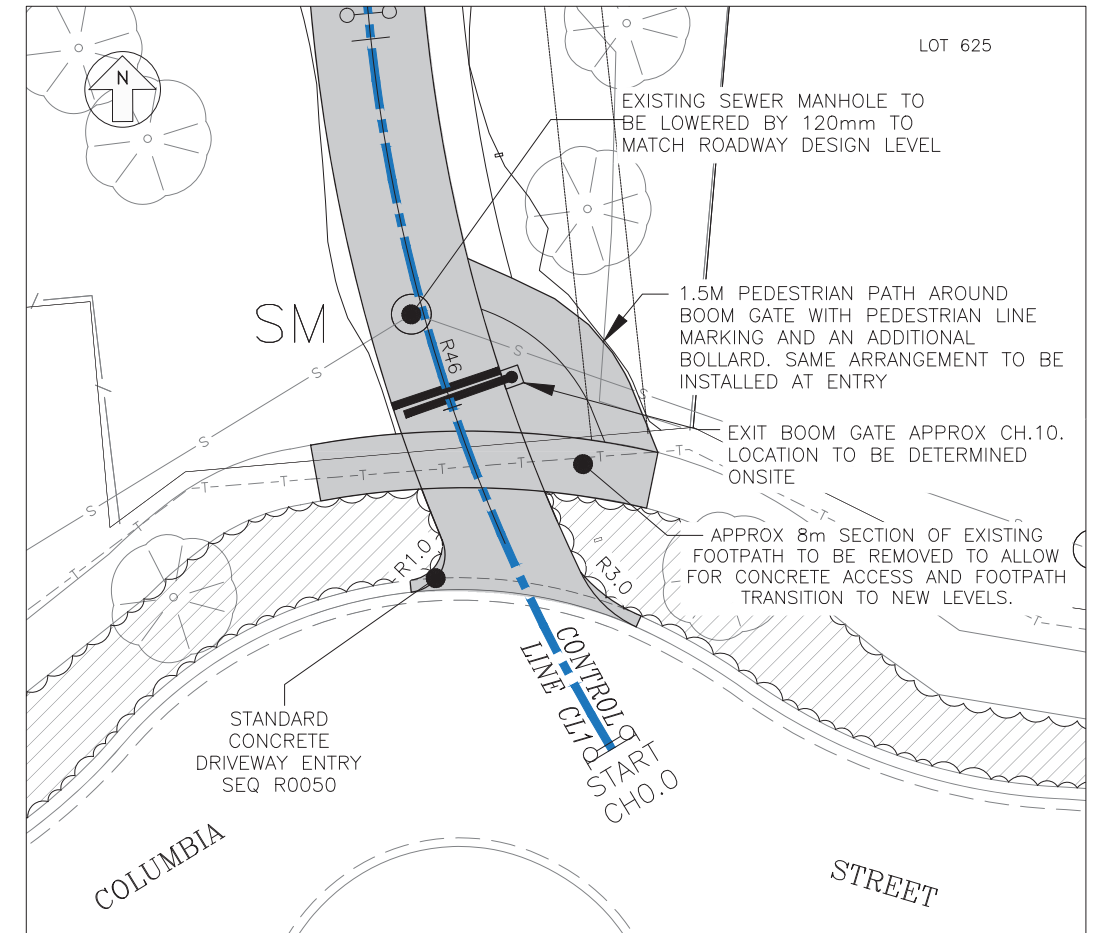

ACCESS EXIT DETAIL PLAN

0 1 2 3 4 5 6m

1:100

Scale 1:100
(Before reduction)

LEGEND

- E — EP — EXIST POWER LINE AND POLE
- T — TE — EXIST TELSTRA LINE AND PIT
- S — SMH — EXIST SEWER LINE AND SEWERAGE MANHOLE
- W — FH — EXIST WATER MAIN AND HYDRANT
- □ — EXIST STORMWATER DRAINAGE PIT AND PIPE
- — — — — EXIST TABLE DRAIN BATTER
- — — — — EXIST KERB & CHANNEL
- — — — — EXIST KERB ONLY
- — — — — STORMWATER PIPE AND PIT
- — — — — DESIGN CONTROL LINE
- △ 5m SURVEY CONTROL STATION

PLAN INDEX

SHEET	DESCRIPTION
C01	SITE PLAN
C02	LONGITUDINAL SECTION
C03	CROSS SECTIONS
C04	CROSS SECTIONS
C05	LINEMARKING AND SIGNAGE PLAN
C06	EROSION AND SEDIMENT CONTROL PLAN

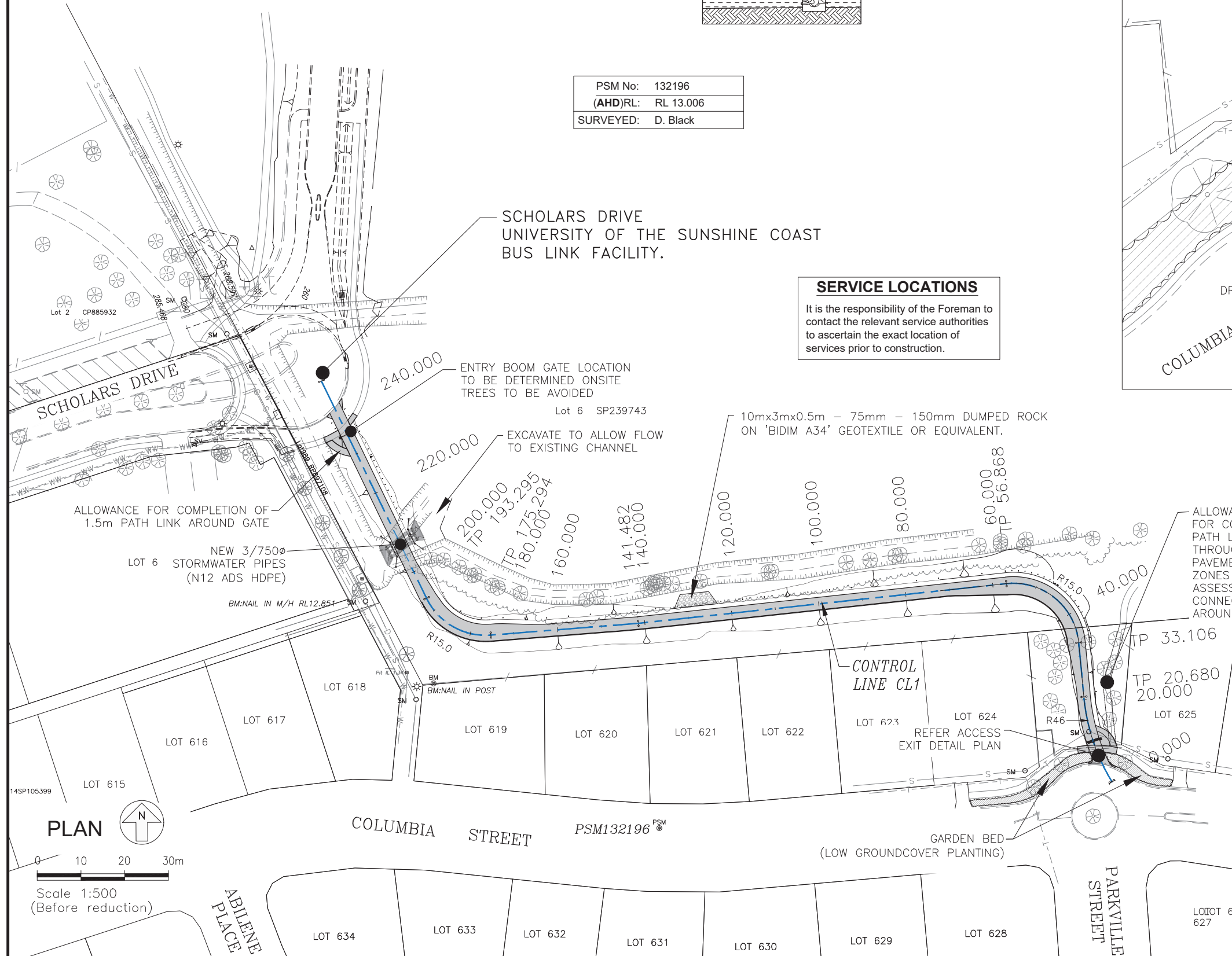

A1	F			
	E			
	D			
	C			
	B			
	A			
Rv	DATE	REVISIONS	REC.	APPR.

DRAWN: H. IZOD
CHECKED: C. CURD
TEAM LDR:
MANAGER:
DIRECTOR:



Bundaberg Office
1/218 Walker St
BUNDABERG QLD
P: (07) 4151 8639

Sunshine Coast
Regional Council

SCHOLARS DRIVE LINK
ONE WAY CONCRETE ACCESS CONNECTING
SCHOLARS DRIVE TO COLUMBIA STREET
SIPPY DOWNS
SITE PLAN

Engineering Cert.
RPEQ: T. Gallagher
RPEQ No: 13396

Project Number
P-H4223
Drawing Sheet No.
C01 Rv.0

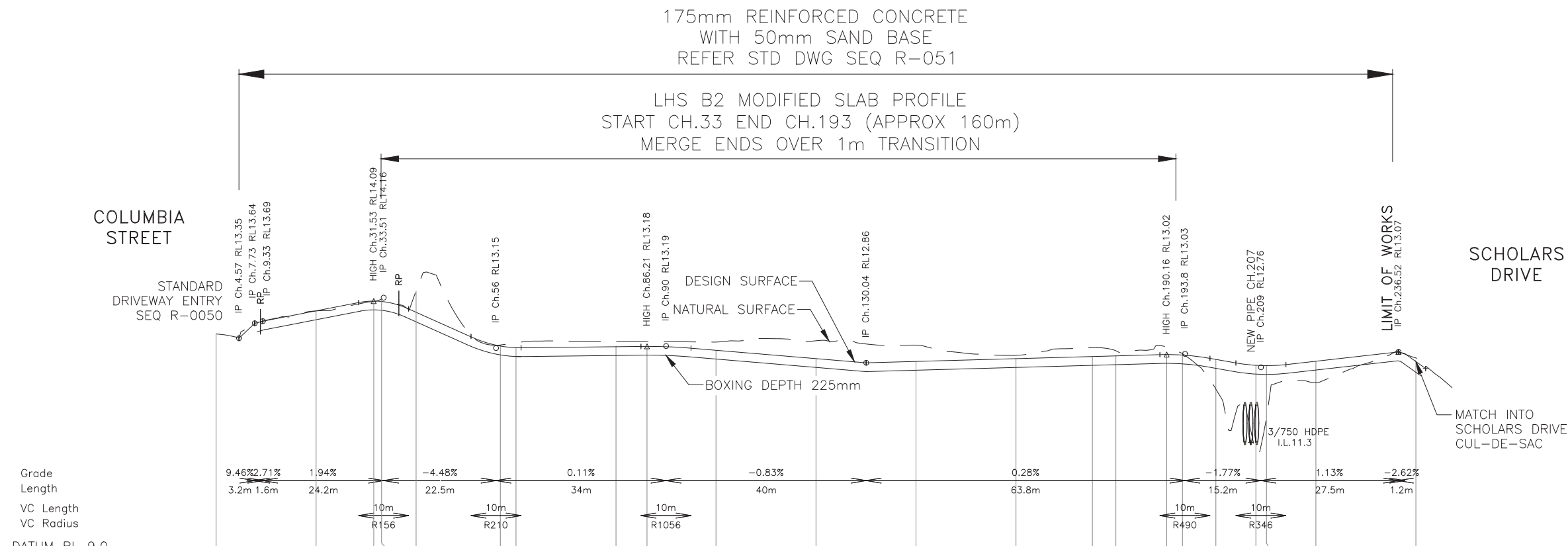

VOLUMES	CUT	1	3	57	18	9	9	7	9	10	0	0	0									
	FILL	2	3	9	11	14	18	10	6	4	25	81	82									
DESIGN CENTERLINE LEVEL	13.433	13.894	14.089	14.081	13.866	13.190	13.157	13.177	13.184	13.105	12.939	12.883	12.938	12.980	12.993	13.020	13.010	12.922	12.804	12.798	12.887	12.879
NATURAL SURFACE LEVEL	13.433	13.891	14.081	14.126	14.291	13.211	13.254	13.282	13.182	13.269	13.296	13.209	13.005	13.160	13.096	13.173	13.040	12.328	11.031	11.754	12.460	12.951
CENTERLINE CHAINAGE	0	20	31.534	33.106	40	56.868	60	80	86.206	100	120	140	160	175.294	180	190.158	193.295	200	208	210.111	220	240

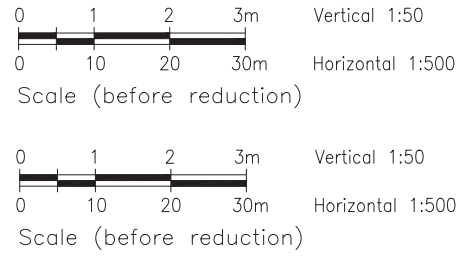
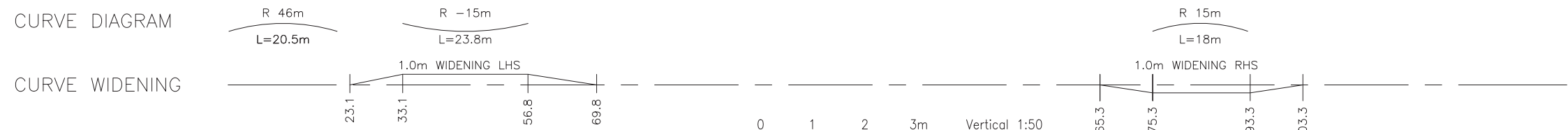

LONGITUDINAL SECTION CL1

A1	F				
	E				
	D				
	C				
	B				
	A				
Rv	DATE	REVISIONS	REC.	APPR.	

DRAWN: H. IZOD
CHECKED: C. CURD
TEAM LDR:
MANAGER:
DIRECTOR:



Bundaberg Office
1/218 Walker St
BUNDABERG QLD
P: (07) 4151 8639

Sunshine Coast
Regional Council

SCHOLARS DRIVE LINK
ONE WAY CONCRETE ACCESS CONNECTING
SCHOLARS DRIVE TO COLUMBIA STREET
SIPPY DOWNS
LONGITUDINAL SECTION

Engineering Cert.
RPEQ: T. Gallagher
RPEQ No: 13396

Project Number
P-H4223
Drawing Sheet No.
C02 Rv.0

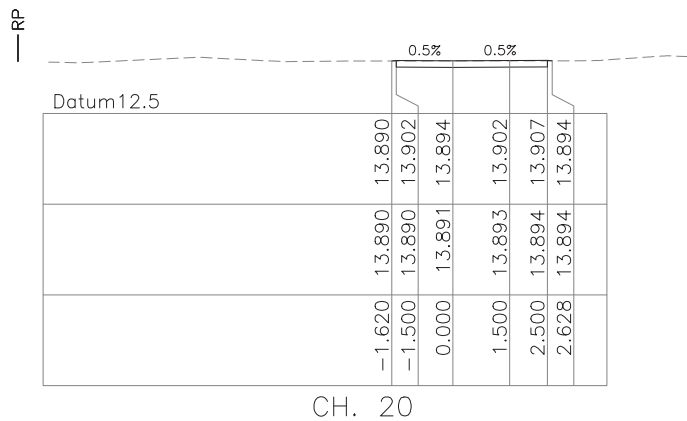

CH. 20

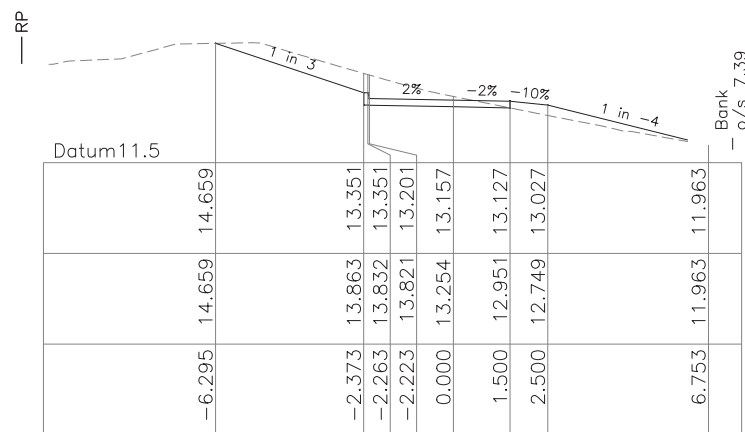

CH. 60

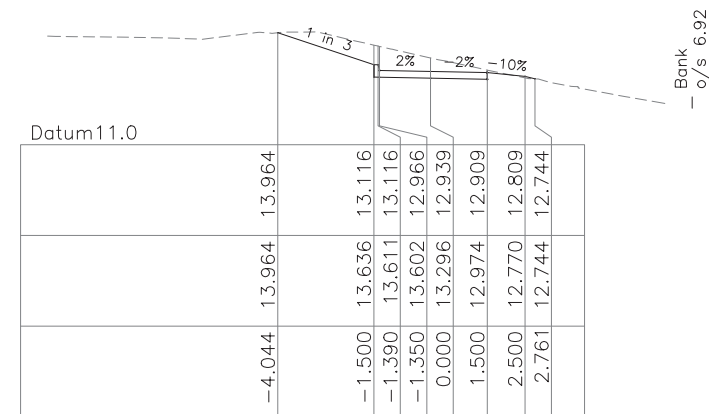

CH. 120

Datum 12.0					
DESIGN LEVELS		13.694	13.708	13.708	13.767
NATURAL SURFACE		13.694	13.695	13.715	13.763
OFFSET		-1.637	-1.500	1.500	4.477
			0.000		4.517

CH. 10

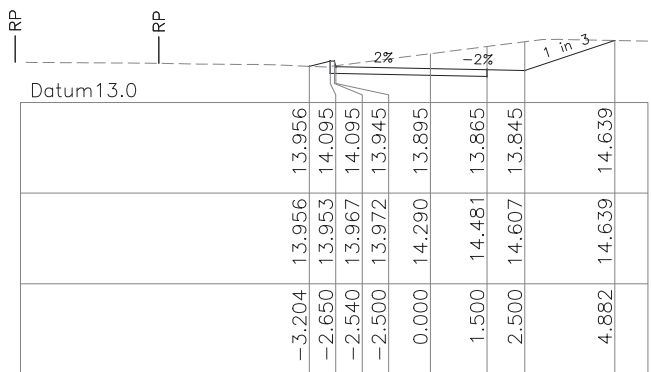

CH. 40

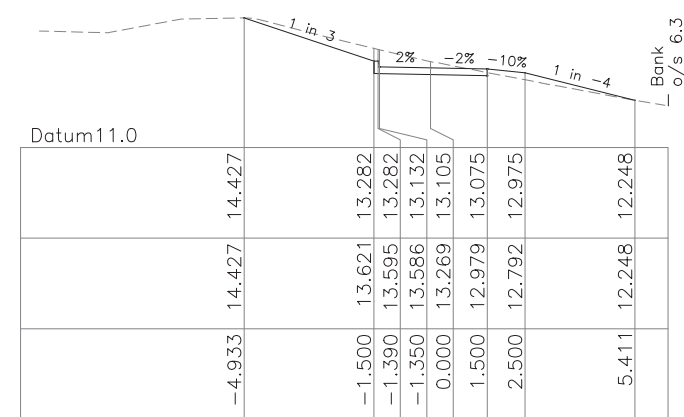

CH. 100

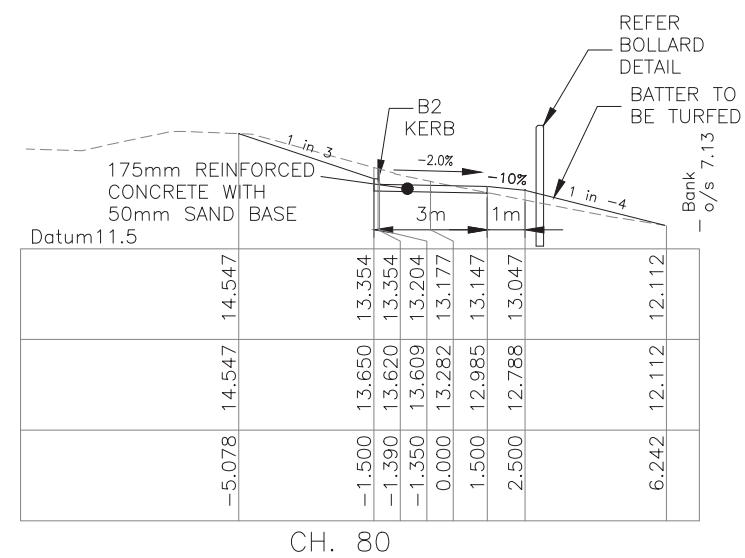
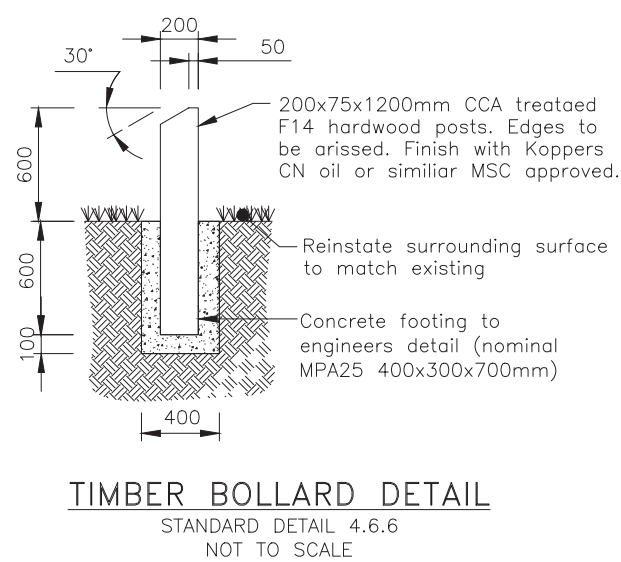
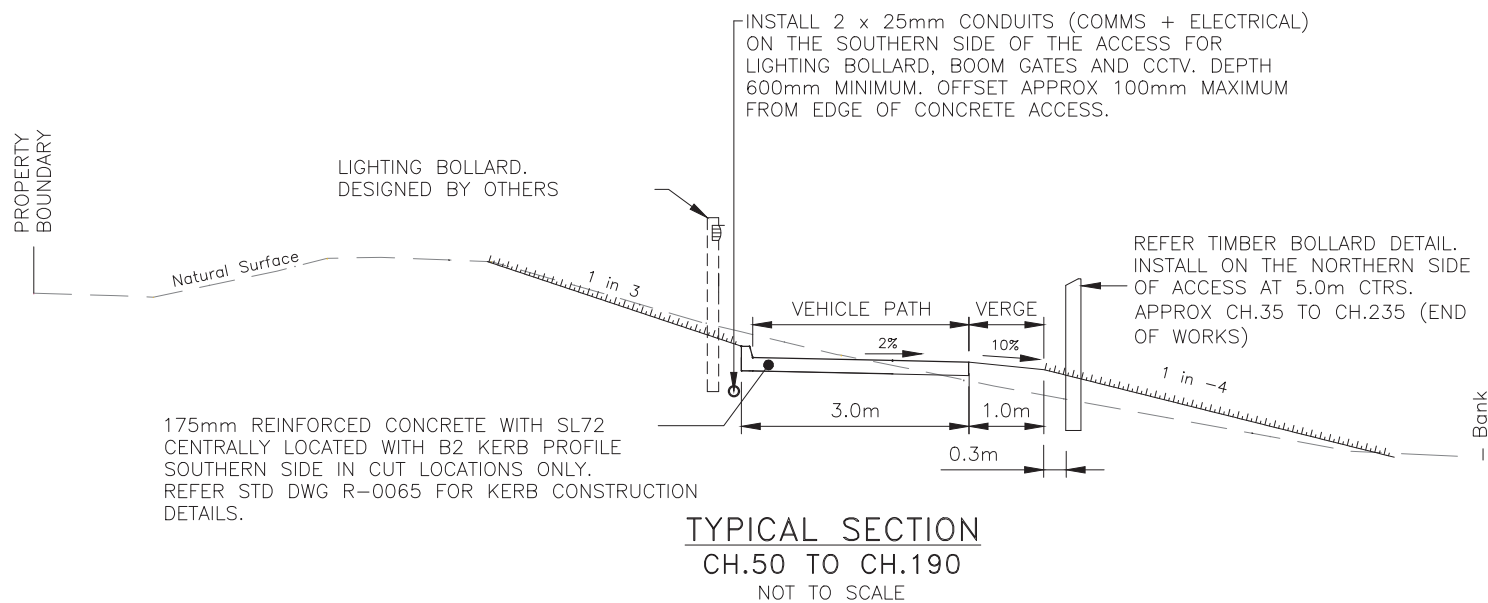

CH. 80

A1	F				
	E				
	D				
	C				
	B				
A					
Rv	DATE	REVISIONS	REC.	APPR.	DIRECTOR:

DRAWN: H. IZOD
 CHECKED: C. CURD
 TEAM LDR:
 MANAGER:
 DIRECTOR:



Bundaberg Office
 1/218 Walker St
 BUNDABERG QLD
 P: (07) 4151 8639

Sunshine Coast
 Regional Council

SCHOLARS DRIVE LINK
 ONE WAY CONCRETE ACCESS CONNECTING
 SCHOLARS DRIVE TO COLUMBIA STREET
 SIPPY DOWNS
CROSS SECTIONS

Engineering Cert.
 RPEQ: T. Gallagher
 RPEQ No: 13396

Project Number
P-H4223
 Drawing Sheet No.
C03 Rv.0

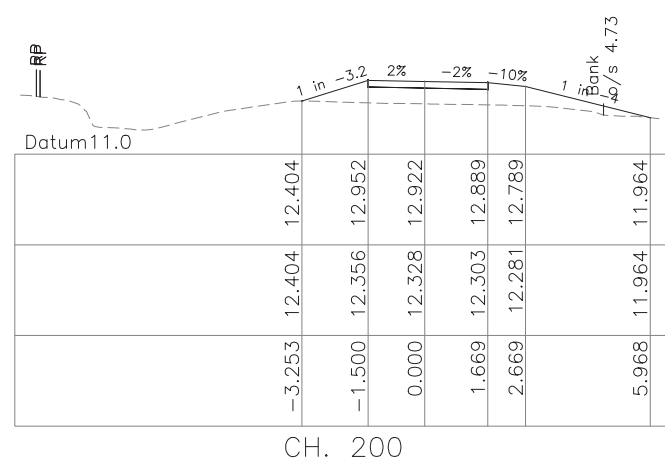
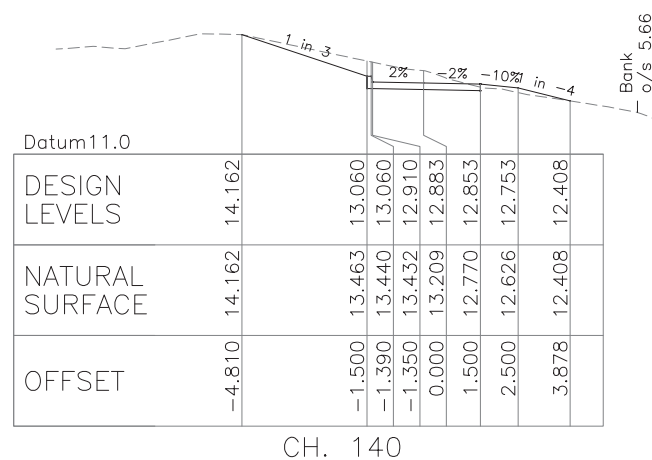
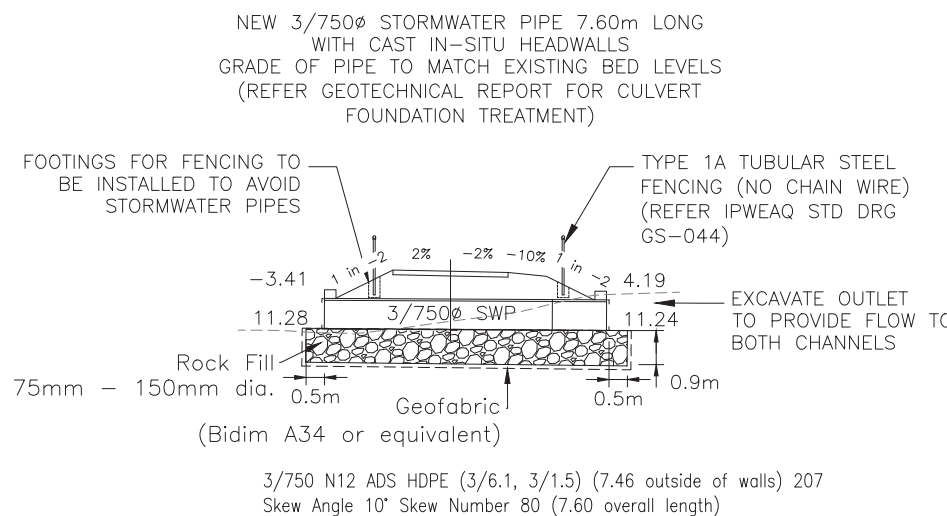
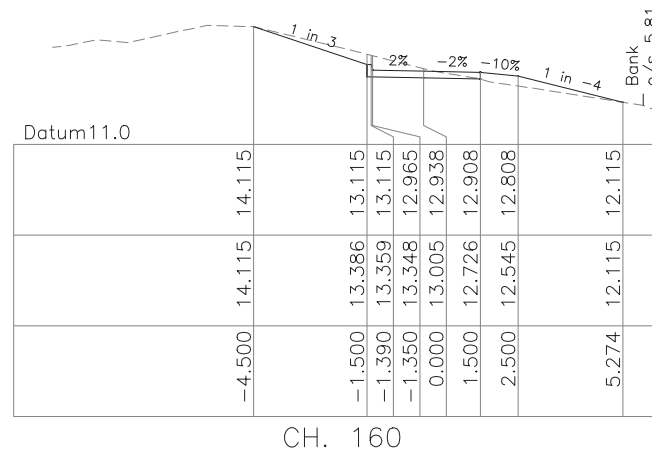
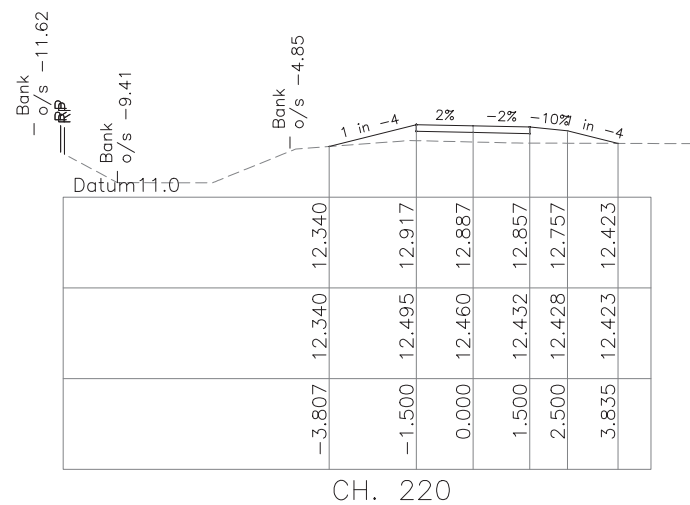
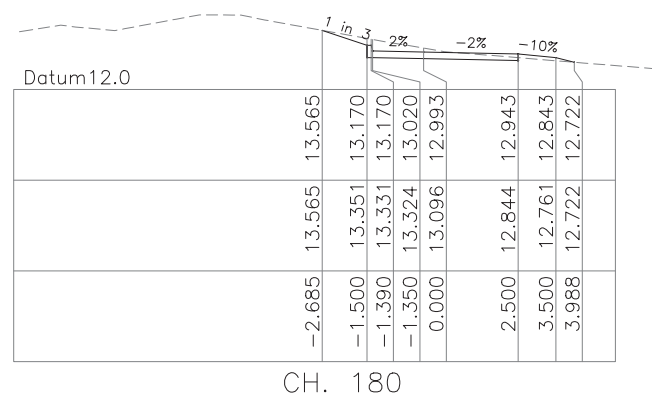

CONTROL LINE CL1 SETOUT					
DESCRIPTION	CH.	X-COORD	Y-COORD	LEVEL	RADIUS
Intersection Point	0.000	506304.277	7044379.978	13.433	
Tangent-Curve	0.168	506304.190	7044380.122	13.431	45.770
Curve	5.000	506301.919	7044384.385	13.366	45.770
Curve	10.000	506300.056	7044389.022	13.607	45.770
Curve	15.000	506298.709	7044393.834	13.820	45.770
Curve	20.000	506297.895	7044398.765	13.900	45.770
Curve-Tangent	20.680	506297.827	7044399.442	13.908	45.770
Straight	30.000	506296.951	7044408.720	14.022	
Tangent-Curve	33.106	506296.659	7044411.813	14.017	-15.000
Curve	35.000	506296.363	7044413.682	13.989	-15.000
Curve	40.000	506294.484	7044418.291	13.822	-15.000
Curve	45.000	506291.201	7044422.031	13.612	-15.000
Curve	50.000	506286.875	7044424.492	13.402	-15.000
Curve	55.000	506281.982	7044425.401	13.226	-15.000
Curve-Tangent	56.868	506280.117	7044425.317	13.188	
Straight	60.000	506277.003	7044424.982	13.156	
Straight	70.000	506267.061	7044423.910	13.166	
Straight	80.000	506257.118	7044422.838	13.177	
Straight	90.000	506247.176	7044421.766	13.177	
Straight	100.000	506237.234	7044420.694	13.105	
Straight	110.000	506227.291	7044419.622	13.022	
Straight	120.000	506217.349	7044418.550	12.939	
Straight	130.000	506207.407	7044417.478	12.855	
Straight	140.000	506197.464	7044416.406	12.883	
Angle	141.482	506195.991	7044416.247	12.887	
Straight	150.000	506187.500	7044415.569	12.911	
Straight	160.000	506177.531	7044414.773	12.939	
Straight	170.000	506167.563	7044413.977	12.968	
Tangent-Curve	173.685	506163.890	7044413.683	12.978	15.000
Curve	175.000	506162.576	7044413.636	12.982	15.000
Curve	180.000	506157.675	7044414.501	12.996	15.000
Curve	185.000	506153.327	7044416.922	13.010	15.000
Curve	190.000	506150.010	7044420.632	13.019	15.000
Curve-Tangent	191.686	506149.192	7044422.106	13.013	15.000
Straight	200.000	506145.572	7044429.590	12.904	
Straight	210.000	506141.219	7044438.593	12.799	
Straight	220.000	506136.865	7044447.596	12.899	
Straight	230.000	506132.512	7044456.598	13.011	
Straight	240.000	506128.158	7044465.601	12.806	

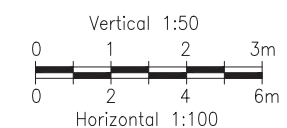

A1	F				
	E				
	D				
	C				
	B				
A					
Rv	DATE	REVISIONS	REC.	APPR.	

DRAWN:	H. IZOD
CHECKED:	C. CURD
TEAM LDR:	
MANAGER:	
DIRECTOR:	

HIG
HARRISON
INFRASTRUCTURE
GROUP
CONSULTING ENGINEERS

Bundaberg Office
1/218 Walker St
BUNDABERG QLD
P: (07) 4151 8639

Sunshine Coast
Regional Council

SCHOLARS DRIVE LINK
ONE WAY CONCRETE ACCESS CONNECTING
SCHOLARS DRIVE TO COLUMBIA STREET
SIPPY DOWNS
CROSS SECTIONS

Engineering Cert.
RPEQ: T. Gallagher
RPEQ No: 13396

Project Number
P-H4223
Drawing Sheet No.
C04 Rv.0

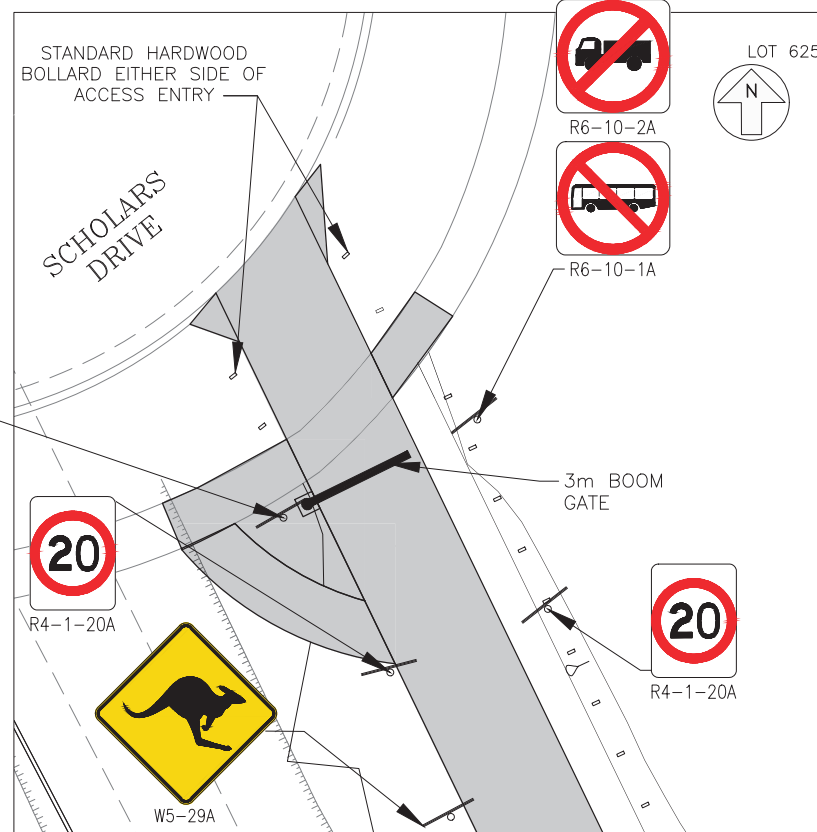

ACCESS ENTRY DETAIL PLAN

1:100

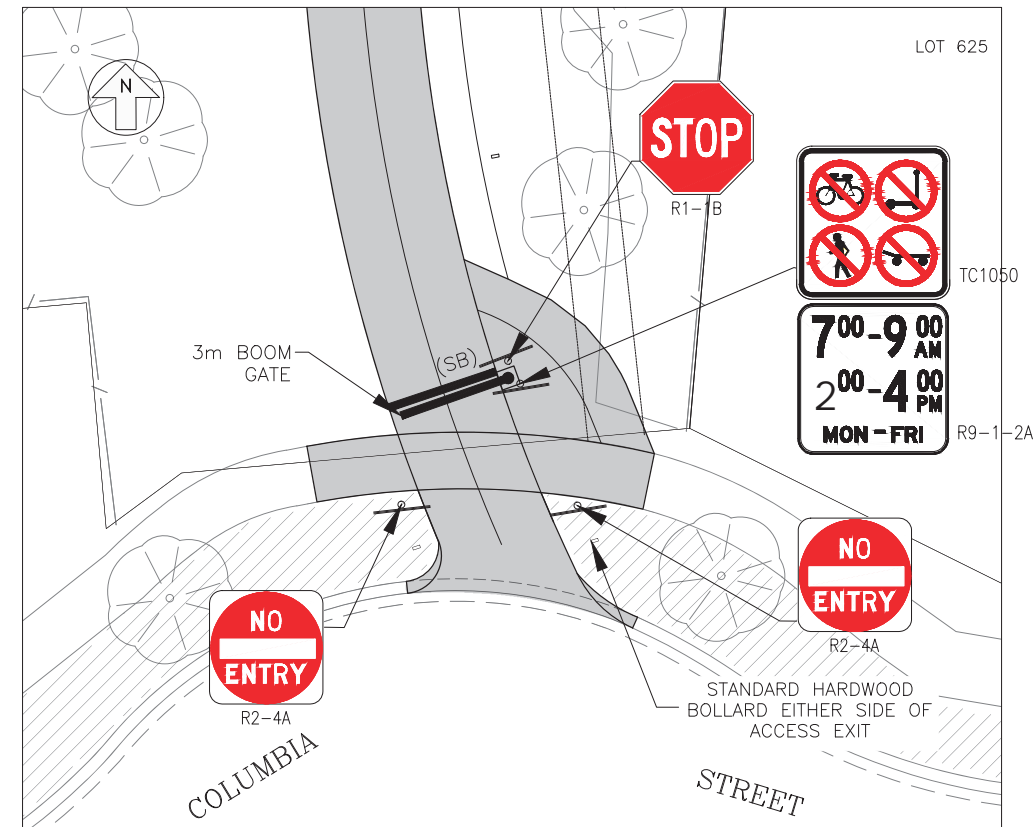

ACCESS EXIT DETAIL PLAN

1:100

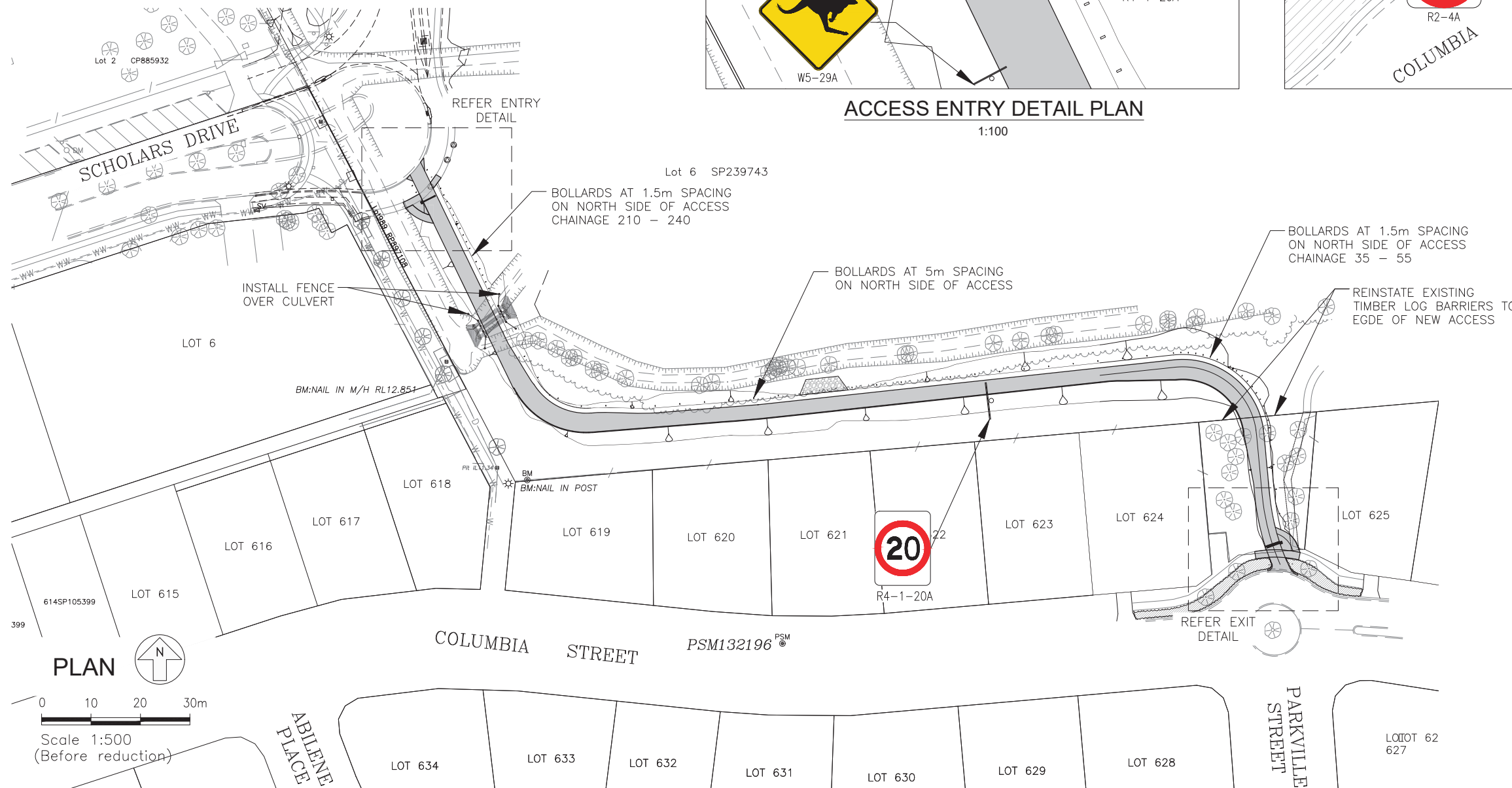

Manual of Uniform Traffic Control Devices

NOTE: ALL SIGNS & LINE MARKING TO BE IN ACCORDANCE WITH THE MANUAL OF UNIFORM TRAFFIC CONTROL DEVICES.

LINEMARKING LEGEND

SCALE 1:1000

LONGITUDINAL LINES

- OTHER
- Edge Lines (EL) 100mm
 - No Stopping Lines (YL) (yellow line) 100mm

TRANSVERSE LINES

- STOP BAR (SB) 300mm

A1	F				
	E				
	D				
	C				
	B				
A					
Rv	DATE	REVISIONS	REC.	APPR.	

DRAWN: H. IZOD
 CHECKED: C. CURD
 TEAM LDR:
 MANAGER:
 DIRECTOR:



Bundaberg Office
 1/218 Walker St
 BUNDABERG QLD
 P: (07) 4151 8639

Sunshine Coast
 Regional Council

SCHOLARS DRIVE LINK
 ONE WAY CONCRETE ACCESS CONNECTING
 SCHOLARS DRIVE TO COLUMBIA STREET
 SIPPY DOWNS
LINEMARKING AND SIGNAGE PLAN

Engineering Cert.

 RPEQ: T. Gallagher
 RPEQ No: 13396

Project Number
P-H4223
 Drawing Sheet No.
C05 Rv.0

SEDIMENT / EROSION CONTROL

- Strip all topsoil from the areas to be filled and stockpile for reuse. Remove all old footings, stumps and rubbish and fill and recompact to the existing surface level with approved material.
- All disturbed areas to be turfed.
- Sediment Fences/Check Dams shall be erected as directed by the Sediment and Erosion Control Plan upon commencement of earthworks and shall be maintained until grass cover is established to the satisfaction of the Engineer. Sediment fences shall be approved silt fence mesh anchored by star pickets at maximum 2.0m centres.
- Mesh covers shall be placed over field inlets pit grates and approved aggregate filled filter blocks shall be placed in all side-entry pit inlets and maintained in position to prevent silt entry to drainage systems until removal is approved by the Engineer.
- Sedimentation Controls shall comply with requirements of "SOIL EROSION AND SEDIMENT CONTROL" - I.E. Aust. Engineering for Queensland .

SEDIMENTATION CONTROL LEGEND

- The following Sediment and Erosion Control standard drawings shall be used in conjunction with this plan but not limited to:
 - SF SD 6-8 SEDIMENT FENCE OR SEDIMENT SOCK
 - SD 6-11 MESH AND GRAVEL INLET FILTER
 - GF SD 6-13 KERBSIDE TURF STRIP (ALL DISTURBED AREAS)

At the prestart meeting the Contractor, USC representative and the Council representative are to define and document the devices and the required locations.

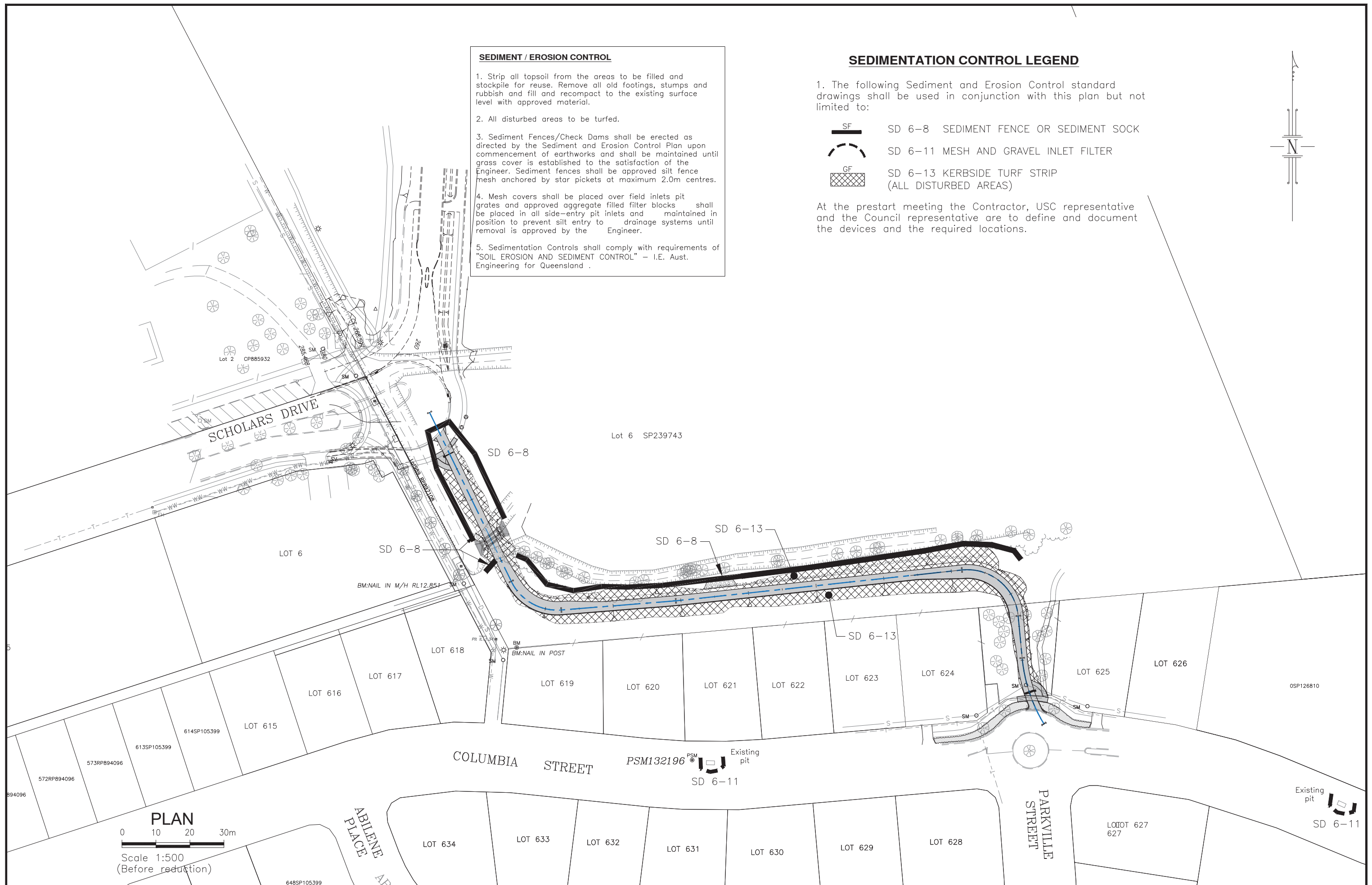
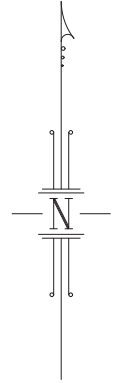

A1	F				
	E				
	D				
	C				
	B				
A					
Rv	DATE	REVISIONS	REC.	APPR.	

DRAWN: H. IZOD
 CHECKED: C. CURD
 TEAM LDR:
 MANAGER:
 DIRECTOR:



Bundaberg Office
 1/218 Walker St
 BUNDABERG QLD
 P: (07) 4151 8639

Sunshine Coast
 Regional Council

SCHOLARS DRIVE LINK
 ONE WAY CONCRETE ACCESS CONNECTING
 SCHOLARS DRIVE TO COLUMBIA STREET
 SIPPY DOWNS
EROSION AND SEDIMENT CONTROL PLAN

Engineering Cert.

 RPEQ: T. Gallagher
 RPEQ No: 13396

Project Number
P-H4223
 Drawing Sheet No.
C06 Rv.0

SWITCHBOARD CONSTRUCTION	
CABINET MATERIAL	MARINE GRADE ALUMINIUM
EXTERNAL FINISH	POWDER COAT (COLOUR: DULUX WOODLAND GREY)
INTERNAL FINISH	POWDER COAT (COLOUR: WHITE)
IP RATING	IP56
HARDWARE	LATCHES - 316SS 1/4 TURN HINGES - 316SS LIFT OFF PINTLE TYPE HANDLES - 316SS 1/4 TURN HANDLES (WITH PADLOCK)
MOUNTING	GALVANISED STEEL POLE
KEYING	AUTHORITY METERING 929 KEY
OTHER	PROVIDE PERMANENT LABELLING AND CIRCUIT SCHEDULE. PROVIDE ALL REQUIRED INTERNAL BUSBARS, TYPE TESTED CHASSIS ASSEMBLIES, LINKS, ACCESSORIES AND CABLING TO SUIT THE SPECIFIED RATING AND PERFORMANCE. PROVIDE ALL REQUIRED ESCUTCHEON CUTOUTS, INCLUDING BLANKING PLATES FOR SPARE/FUTURE ACCESSORIES.

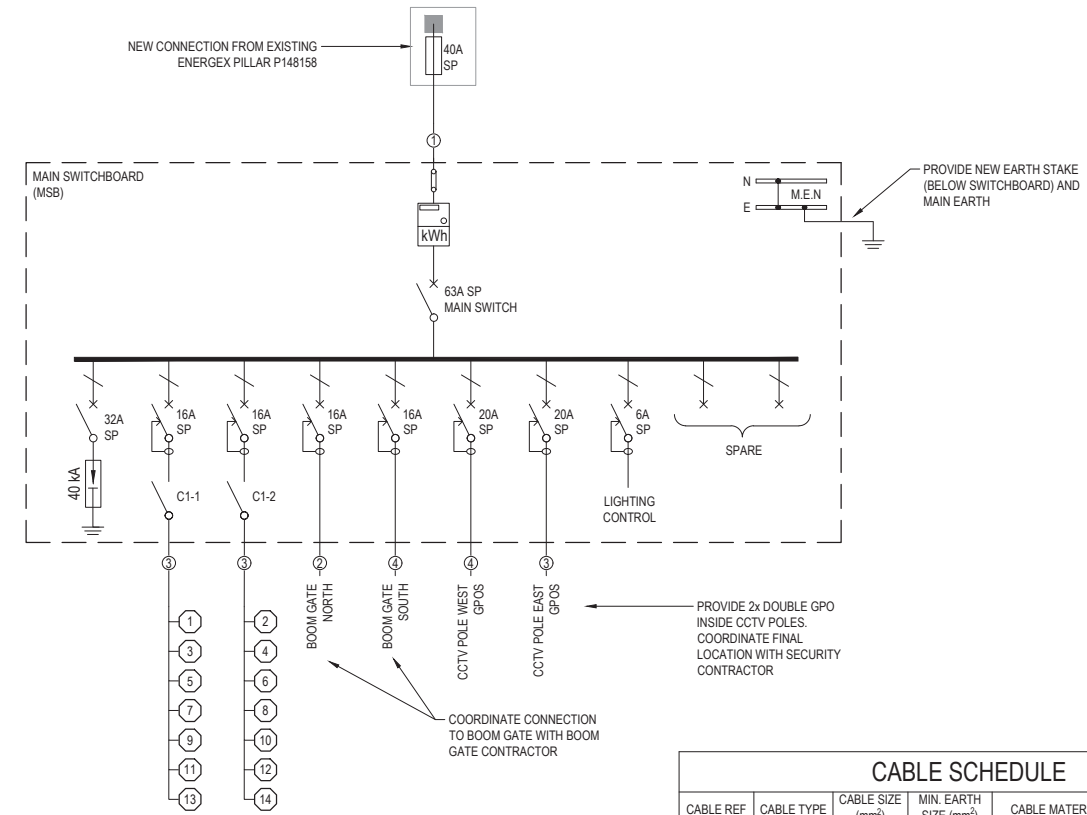

CABLE SCHEDULE					
CABLE REF	CABLE TYPE	CABLE SIZE (mm ²)	MIN. EARTH SIZE (mm ²)	CABLE MATERIAL	INSULATION/SHEATH MATERIAL
1	1x2 CORE	16	-	Cu (SOLID/STRANDED)	XLPE/PVC
2	1x2 CORE + E	2.5	2.5	Cu (SOLID/STRANDED)	XLPE/PVC
3	1x2 CORE + E	6	6	Cu (SOLID/STRANDED)	XLPE/PVC
4	1x2 CORE + E	10	6	Cu (SOLID/STRANDED)	XLPE/PVC

SINGLE LINE DIAGRAM

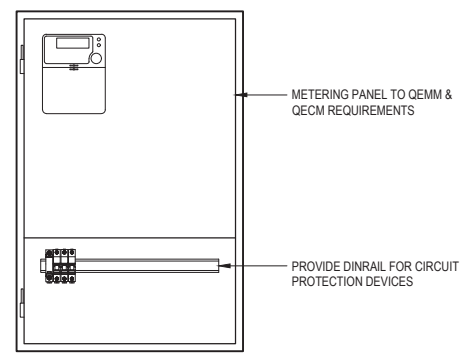
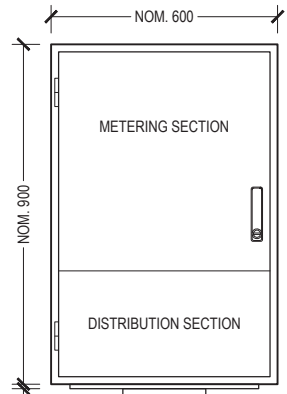

INDICATIVE MAIN SWITCHBOARD DOOR REMOVED
N.T.S.

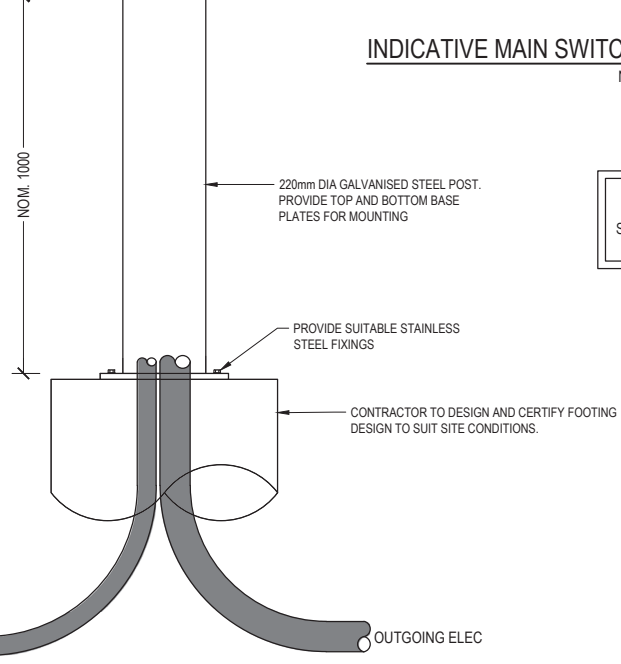

INDICATIVE MAIN SWITCHBOARD POST MOUNTED
N.T.S.

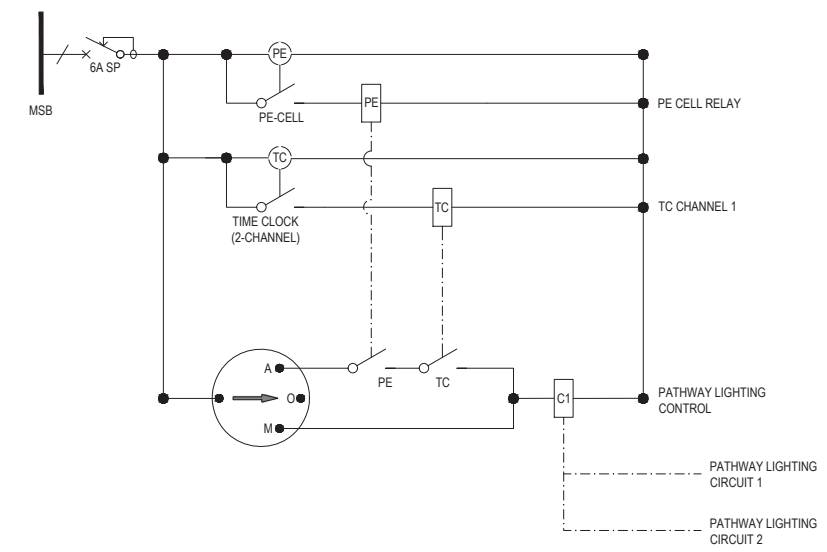

LIGHTING CONTROL SCHEMATIC

PROVIDE LABELLING TO ROTARY SWITCH ("PATHWAY LIGHTING") AND CONFIGURE TIME-CLOCK & PE SETTINGS DURING COMMISSIONING.

CONTROL NOTES

- LIGHTING CONTROL INTENT AS FOLLOWS:
- CONTROL CIRCUIT FOR STREETLIGHTING TO BE LOCATED IN RATE 3 SWITCHBOARD (TYPICAL).
 - PROVIDE AUTO-OFF-MANUAL CONTROL SWITCH AND APPROPRIATE LABELLING.
 - AUTOMATIC CONTROL BASED ON PE-CELL / 1-CHANNEL TIME CLOCK.
 - CONTROL FUNCTIONALITY AS FOLLOWS:
 - "ON" AT DUSK (VIA PE CELL)
 - "OFF" AT DAWN (VIA PE CELL) OR "OFF" AT PRE-SET TIME (VIA TIME CLOCK CHANNEL 1).
 - CONFIRM TIME CLOCK SETTINGS DURING COMMISSIONING.

BOLLARDS SETOUT

POLE ID	EASTINGS	NORTHINGS	SETBACK	LUMINAIRE
1	506128.096	7044457.231	0.7	J1
2	506135.281	7044442.373	0.7	J1
3	506142.467	7044427.520	0.7	J1
4	506151.654	7044414.133	0.7	J1
5	506167.584	7044411.771	0.7	J1
6	506184.032	7044413.087	0.7	J1
7	506200.469	7044414.522	0.7	J1
8	506216.873	7044416.293	0.7	J1
9	506233.278	7044418.060	0.7	J1
10	506249.683	7044419.828	0.7	J1
11	506266.088	7044421.599	0.7	J1
12	506282.597	7044422.021	0.7	J1
13	506293.009	7044413.300	0.7	J1
14	506295.640	7044399.192	0.7	J1

NOTE: BOLLARDS COORDINATES SHOWN FOR REFERENCE ONLY. COORDINATE POLE SETOUT ON SITE TO ACHIEVE NOMINATED SETBACK FROM EDGE OF PATHWAY

A1	Rv	DATE	REVISIONS	REC.	APPR.
4		14.03.22	TENDER ISSUE	C.L.	C.L.
3		02.03.22	TENDER ISSUE	C.L.	C.L.
2		14.02.22	REVISED PRELIMINARY ISSUE	C.L.	C.L.
1		29.10.21	PRELIMINARY ISSUE	C.L.	C.L.

SURVEYED	
DRAWN	B.GRANT
CHECKED	C.LITTLETON
REVIEWED	C.LITTLETON
COORDINATOR	C.LITTLETON

WEBB AUSTRALIA GROUP - ACN 010 733 561
 CAPITAL ONE COMPLEX, SUITE 13A
 5 CAPITAL PLACE BIRRTINIA QLD 4375
 TELEPHONE: (07) 5438 8800
 FACSIMILE: (07) 3870 4100
 EMAIL: sunshinecoast@webb.australia.com.au

CONSULTING ELECTRICAL ENGINEERS - MECHANICAL CONSULTANTS
 LIGHTING CONSULTANTS - TECHNOLOGY CONSULTANTS - COMMUNICATIONS CONSULTANTS
 COPYRIGHT © 2018 WEBB AUSTRALIA GROUP (ASD) PTY LTD ACN 010 733 561. ALL RIGHTS RESERVED. THIS DOCUMENT IS NOT TO BE REPRODUCED OR TRANSMITTED IN ANY FORM OR BY ANY MEANS WITHOUT THE WRITTEN PERMISSION OF WEBB AUSTRALIA GROUP (ASD) PTY LTD. WEBB AUSTRALIA GROUP (ASD) PTY LTD IS A COMPANY OF AUSTRALIA. THE COMPANY IS NOT RESPONSIBLE FOR ANY ERRORS OR OMISSIONS IN THIS DOCUMENT. THE COMPANY IS NOT RESPONSIBLE FOR ANY ERRORS OR OMISSIONS IN THIS DOCUMENT. THE COMPANY IS NOT RESPONSIBLE FOR ANY ERRORS OR OMISSIONS IN THIS DOCUMENT.

SCHOLARS DRIVE LINK LIGHTING, SIPPY DOWNS
 ELECTRICAL SERVICES
 DETAILS & SCHEMATICS

Project Number:	Q210A
Sheet No. - Revision No.	E002 4

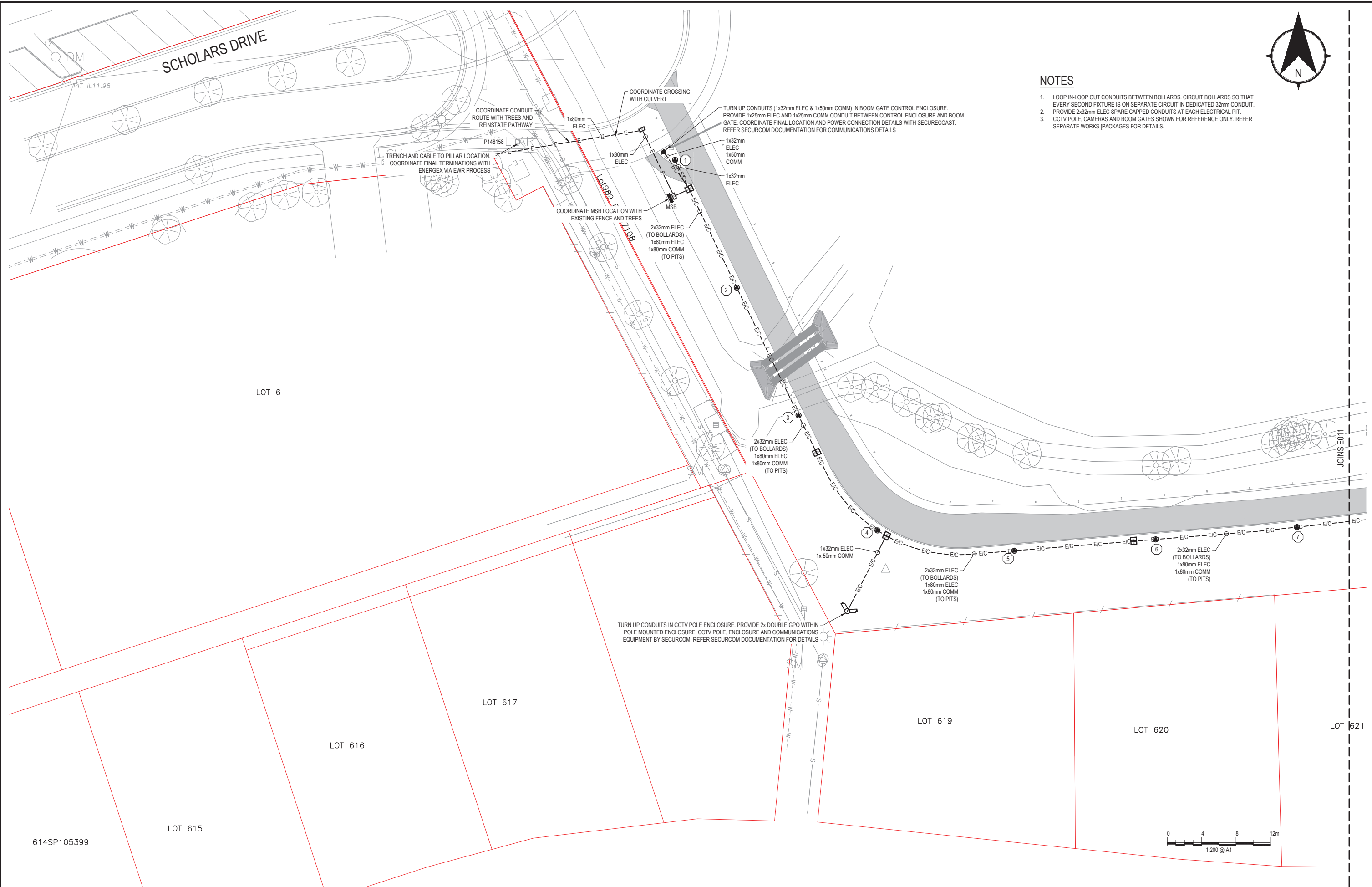

NOTES

1. LOOP IN-LOOP OUT CONDUITS BETWEEN BOLLARDS. CIRCUIT BOLLARDS SO THAT EVERY SECOND FIXTURE IS ON SEPARATE CIRCUIT IN DEDICATED 32mm CONDUIT.
2. PROVIDE 2x32mm ELEC SPARE CAPPED CONDUITS AT EACH ELECTRICAL PIT.
3. CCTV POLE, CAMERAS AND BOOM GATES SHOWN FOR REFERENCE ONLY. REFER SEPARATE WORKS (PACKAGES FOR DETAILS).



A1	3	02.03.22	TENDER ISSUE	C.L.	C.L.
	2	14.02.22	REVISED PRELIMINARY ISSUE	C.L.	C.L.
	1	29.10.21	PRELIMINARY ISSUE	C.L.	C.L.
	Rv	DATE	REVISIONS	REC.	APPR.

SURVEYED	
DRAWN	B.GRANT
CHECKED	C.LITTLETON
REVIEWED	C.LITTLETON
COORDINATOR	C.LITTLETON

WEBB AUSTRALIA GROUP - ACN 010 733 561
 CAPITAL ONE COMPLEX, SUITE 13A
 8 CAPITAL PLACE BIRKTINA QLD 4375
 TELEPHONE: (07) 5438 8800
 FACSIMILE: (07) 3870 4100
 EMAIL: sunshinecoast@webbaustralia.com.au

0210A
 CONSULTING ELECTRICAL ENGINEERS, MECHANICAL CONSULTANTS
 COPYRIGHT © 2016 WEBB AUSTRALIA GROUP (ASD) PTY LTD. ALL RIGHTS RESERVED. THIS DOCUMENT IS NOT TO BE REPRODUCED OR TRANSMITTED IN ANY FORM OR BY ANY MEANS WITHOUT THE WRITTEN PERMISSION OF WEBB AUSTRALIA GROUP (ASD) PTY LTD. WEBB AUSTRALIA GROUP (ASD) PTY LTD. IS A COMPANY OF THE COMMONWEALTH OF AUSTRALIA. THIS DOCUMENT IS NOT TO BE REPRODUCED OR TRANSMITTED IN ANY FORM OR BY ANY MEANS WITHOUT THE WRITTEN PERMISSION OF THE COMMONWEALTH OF AUSTRALIA.

Sunshine Coast
 COUNCIL

SCHOLARS DRIVE LINK LIGHTING, SIPPY DOWNS
 ELECTRICAL SERVICES
 LAYOUT PLAN - SHEET 1 OF 2

Project Number:	Q210A
Sheet No. - Revision No.	E010 3

LOT 619



NOTES

1. LOOP IN-LOOP OUT CONDUITS BETWEEN BOLLARDS. CIRCUIT BOLLARDS SO THAT EVERY SECOND FIXTURE IS ON SEPARATE CIRCUIT IN DEDICATED 32mm CONDUIT.
2. PROVIDE 2x32mm ELEC SPARE CAPPED CONDUITS AT EACH ELECTRICAL PIT.
3. CCTV POLE, CAMERAS AND BOOM GATES SHOWN FOR REFERENCE ONLY. REFER SEPARATE WORKS PACKAGES FOR DETAILS.

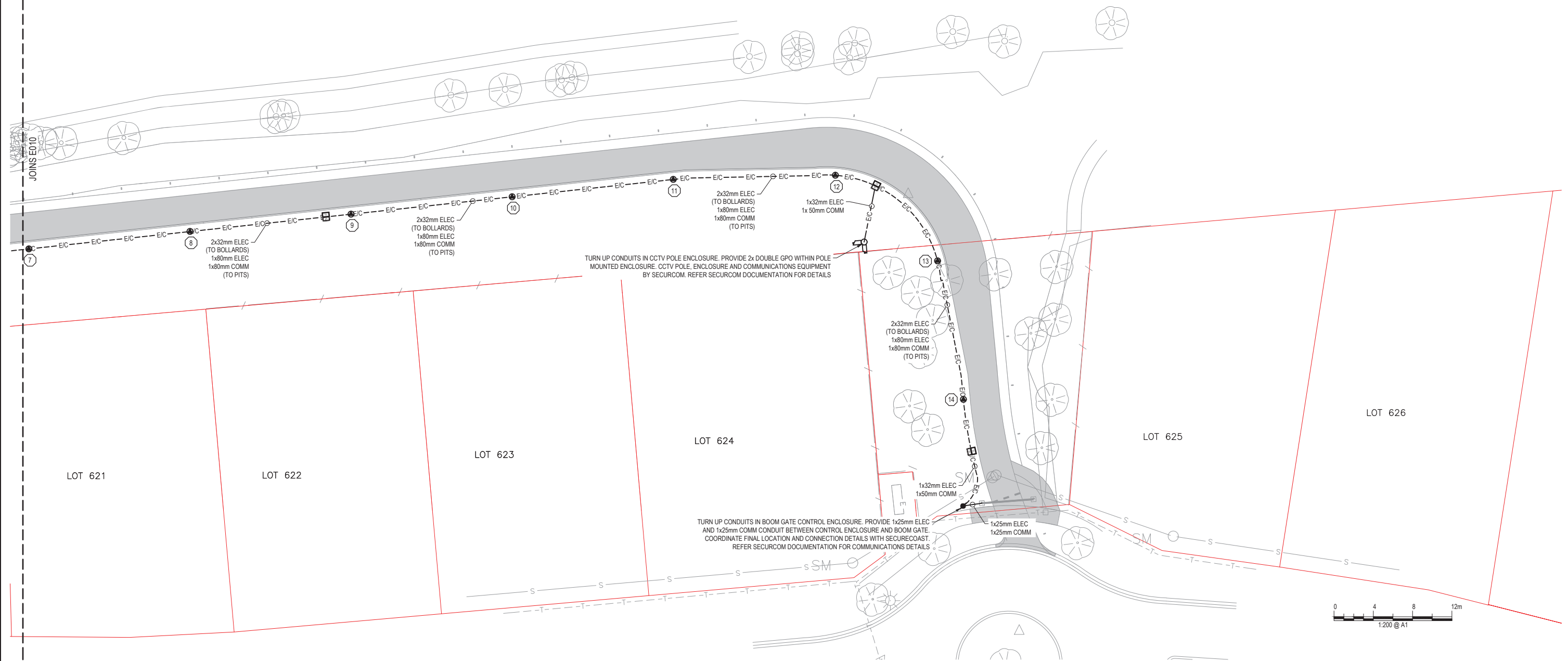

A1						
	3	02.03.22	TENDER ISSUE	C.L.	C.L.	
	2	14.02.22	REVISED PRELIMINARY ISSUE	C.L.	C.L.	
	1	29.10.21	PRELIMINARY ISSUE	C.L.	C.L.	
	Rv.	DATE	REVISIONS	REC.	APPR.	

SURVEYED	
DRAWN	B.GRANT
CHECKED	C.LITTLETON
REVIEWED	C.LITTLETON
COORDINATOR	C.LITTLETON

WEBB AUSTRALIA GROUP - ACN 010 733 561
 CAPITAL ONE COMPLEX, SUITE 13A
 8 CAPITAL PLACE BIRTMINGHAM QLD 4315
 TELEPHONE: (07) 5438 8800
 FACSIMILE: (07) 3870 4100
 EMAIL: sunshinecoast@webbaustralia.com.au

Q210A
 CONSULTING ELECTRICAL ENGINEERS, MECHANICAL CONSULTANTS
 LIGHTING CONSULTANTS, TECHNOLOGY CONSULTANTS, COMMUNICATIONS CONSULTANTS
 COPYRIGHT © 2018 WEBB AUSTRALIA GROUP (ASD) PTY LTD AND ITS RELS. ALL RIGHTS RESERVED. THIS DOCUMENT IS THE PROPERTY OF WEBB AUSTRALIA GROUP (ASD) PTY LTD. WEBB AUSTRALIA GROUP (ASD) PTY LTD AND ITS RELS. SHALL BE HELD IN CONNECTION WITH ALL CONTRACT DOCUMENTATION. SHOULD ANY AMBIGUITY, ERROR, OMISSION, DISCREPANCY, INCONSISTENCY OR OTHER FAULT APPEAR TO EXIST IN THE DOCUMENTS, IMMEDIATELY NOTIFY THE CONTRACT ADMINISTRATION IN WRITING.

Sunshine Coast COUNCIL

SCHOLARS DRIVE LINK LIGHTING, SIPPY DOWNS
 ELECTRICAL SERVICES
 LAYOUT PLAN - SHEET 2 OF 2

Project Number:	Q210A
Sheet No. - Revision No.	E011 3

FILE:G:\Q210A - SCHOLARS DR LINK LIGHTING\01 WEBB01 ELECTRICAL\E011.dwg DATE:02/Mar/2022 BY:bgran

CERTIFICATE OF COMPLIANCE DESIGN DOCUMENTATION IN ACCORDANCE WITH THE REQUIREMENTS OF AS/NZS 1158.3.1:2020 APPENDIX E		
LOCATION:	SCHOLARS DRIVE, SIPPY DOWNS	
LIGHTING CATEGORY:	PP4	
INSTALLATION ARRANGEMENT / GEOMETRY:		
- LUMINAIRE MOUNTING HEIGHT (H):	1100mm	
- LUMINAIRE OUTREACH:	-	
- POLE SETBACK:	700mm	
- UPCAIST ANGLE:	0 DEGREES	
LUMINAIRE / LAMP DETAILS:		
- LUMINAIRE IDENTIFICATION:	THORLUX PASSWAY BOLLARD	
- LUMINAIRE WATTAGE:	11W	
- LUMINAIRE COLOUR TEMPERATURE:	3000K	
- LAMP TYPE:	LED	
- LUMINAIRE LUMEN OUTPUT:	780lm	
PHOTOMETRIC DATA DETAILS:		
- ORIGIN OF NATA CERTIFIED PHOTOMETRIC DATA:	MANUFACTURER PROVIDED	
LIGHT TECHNICAL PARAMETERS:	TARGET	CALCULATED
- AVERAGE HORIZONTAL ILLUMINANCE (E _h):	1.5	8.78
- POINT HORIZONTAL ILLUMINANCE (E _{ph}):	0.25	0.3
- POINT VERTICAL ILLUMINANCE (E _{pv}):	0.05	-
- ILLUMINANCE UNIFORMITY CATEGORY (U _{e2}):	≤ 5	3.84
ROAD SURFACE CHARACTERISTICS DETAILS:		
- ROAD SURFACE REFLECTION CHARACTERISTIC:	CIE-R3	
- COMPUTER PROGRAM:	AGI32	
- MAINTENANCE FACTOR:	0.8	

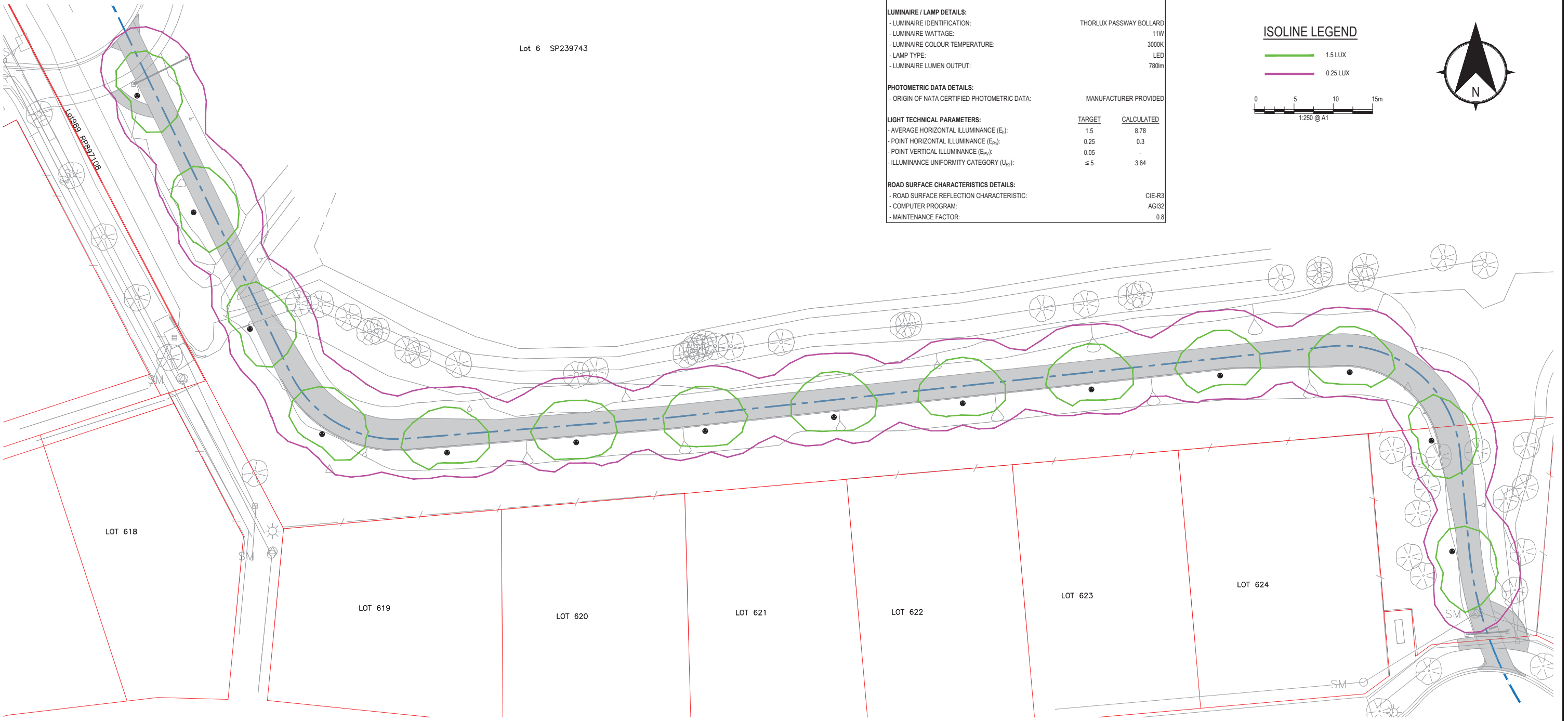
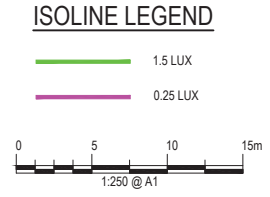

A1	3	02.03.22	TENDER ISSUE	C.L.	C.L.	SURVEYED	
	2	14.02.22	REVISED PRELIMINARY ISSUE	C.L.	C.L.	DRAWN	B.GRANT
	1	29.10.21	PRELIMINARY ISSUE	C.L.	C.L.	CHECKED	C.LITTLETON
	Rv	DATE	REVISIONS	REC.	APPR.	REVIEWED	C.LITTLETON
						COORDINATOR	C.LITTLETON

WEBB AUSTRALIA GROUP - ACN 010 733 561
CAPITAL ONE COMPLEX, SUITE 13A
8 CAPITAL PLACE BIRTMINGHAM, QLD 4315

TELEPHONE: (07) 5438 8800
FACSIMILE: (07) 3870 4100
EMAIL: sunshinecoast@webbaustralia.com.au

Q210A

CONSULTING ELECTRICAL ENGINEERS, MECHANICAL CONSULTANTS
LIGHTING CONSULTANTS, TECHNOLOGY CONSULTANTS, COMMUNICATIONS CONSULTANTS
COPYRIGHT © 2018 WEBB AUSTRALIA GROUP (ASD) PTY LTD. ALL RIGHTS RESERVED. THIS DOCUMENT IS NOT BE REPRODUCED OR TRANSMITTED IN ANY FORM OR BY ANY MEANS WITHOUT THE WRITTEN PERMISSION OF WEBB AUSTRALIA GROUP (ASD) PTY LTD. WEBB AUSTRALIA GROUP (ASD) PTY LTD. IS NOT RESPONSIBLE FOR ANY ERRORS, OMISSIONS, DISCREPANCY, INCONSISTENCY OR OTHER FAULTS TO APPEAR IN THIS DOCUMENT. IMMEDIATE NOTIFY THE CONTRACT ADMINISTRATOR IN WRITING.

Sunshine Coast
COUNCIL

SCHOLARS DRIVE LINK LIGHTING, SIPPY DOWNS
ELECTRICAL SERVICES
ISOLUX PLOT AND CERTIFICATE OF COMPLIANCE

Project Number:
Q210A
Sheet No. - Revision No.
E020 3

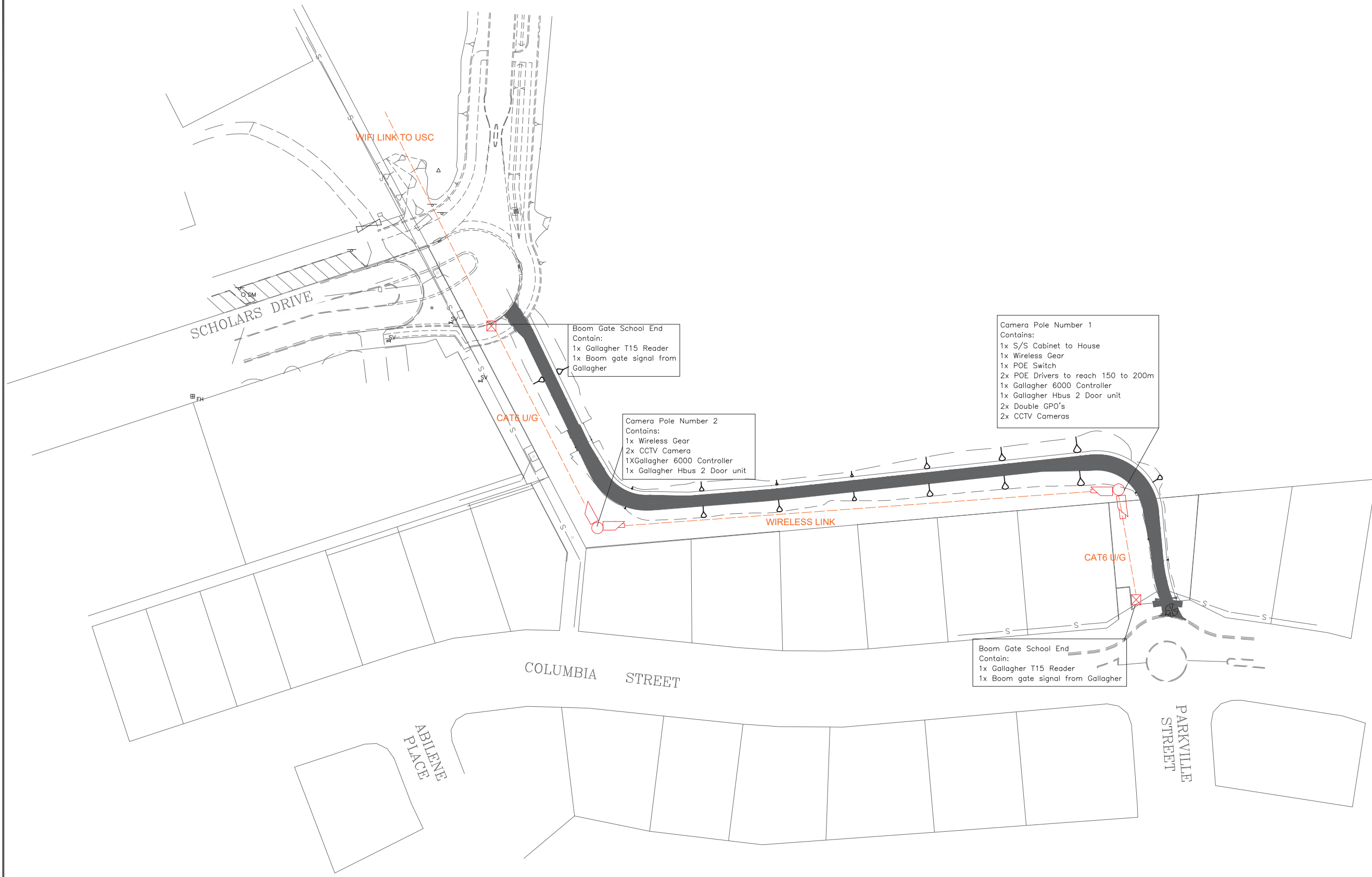

Boom Gate School End
Contain:
1x Gallagher T15 Reader
1x Boom gate signal from
Gallagher

Camera Pole Number 2
Contains:
1x Wireless Gear
2x CCTV Camera
1x Gallagher 6000 Controller
1x Gallagher Hbus 2 Door unit

Camera Pole Number 1
Contains:
1x S/S Cabinet to House
1x Wireless Gear
1x POE Switch
2x POE Drivers to reach 150 to 200m
1x Gallagher 6000 Controller
1x Gallagher Hbus 2 Door unit
2x Double GPO's
2x CCTV Cameras

Boom Gate School End
Contain:
1x Gallagher T15 Reader
1x Boom gate signal from Gallagher

AMENDMENTS

ISSUE DATE	SUBJECT	AUTHORISED



SECURCOM PTY LTD
ABN: 78 091 110 002
Unit 79/193 South Pine Road
Brendale QLD 4500
Phone: 1300 539 239
Fax: 1300 539 739
email: info@securcom.com.au
Web: www.securcom.com.au

S.M DRAWN	JAN, 2022 DATE
H.L DISCIPLINE TEAM LEADER	JAN, 2022 DATE
H.L AUTHORISED FOR ISSUE	JAN, 2022 DATE

SUNSHINE COAST COUNCIL
SCHOLARS DR- COLUMBIA ST

PURPOSED CCTV
SECURITY LAYOUT
ELECTRONIC SERVICE

SCALE N/A	AT A1 SIZE
MASTER SITE NUMBER 8963	CLIENT REFERENCE NUMBER C06
DRAWING NUMBER SEC-SCC-CCTV-S1	ISSUE SHEET NO





Note:
 All plantings should be positioned at least 1m from residents property fence line.
 Ensure all plants abutting the road and fence lines are set back to cater for mature growth, size & habitat so pruning is minimised.
 Treatment in the DOR section to consist of turf.



Planting Method

1. Site Preparation - Weed removal where required
2. Plant local provenance, native tube stock according to Planting Plan and Species suggestions in Plant Schedule.
3. Spacings of 1.5 - 2 m between tree and shrub species and 0.5 m between groundcover species.
4. Heavy forest mulch 100mm in depth to be used to aid establishment and restrict weed growth.
5. Slow release fertiliser tablet to be used for each individual plant.
6. Water crystals to be used for each plant in areas of sandy substrate.
7. Scheduled maintenance over a 12 month period to ensure establishment of plants, replacement of dead plants and control of weed species.



Watering

1. Irrigation by water truck at time of planting
2. Regularly check moisture levels and maintain watering during dry periods

Planting Schedule

Shrub/ Groundcover species

<i>Westringia fruticosa</i>	Coastal rosemary
<i>Melaleuca sp. cultivar</i>	"claret tops/ captain cook"
<i>Grevillea sp. cultivar</i>	"orange marmalade/robin gordon/honeygem"
<i>Carissa macrocarpa</i>	Natal plum
<i>Lomandra confertifolia/longifolia</i>	Spiny-headed/ Pale mat rush
<i>Ficinia nodosa</i>	Knobby club-rush
<i>Dianella brevipedunculatus</i>	Short-flowered flax lily
<i>Hakea actites</i>	Wallum hakea
<i>Melastoma malabathricum</i>	Blue tongue
<i>Pultanea villosa</i>	Hairy bush-pea
<i>Hovea acutifolia</i>	Purple pea bush
<i>Baeckea imbricata</i>	Spindly baeckea
<i>Leptospermum petersonii/ polygalifolium</i>	Lemon-scented tea tree/ Wild may

Screening species

<i>Pittosporum revolutum</i>	Forest pittosporum
<i>Sannantha bidwillii</i>	North coast twiggy myrtle
<i>Acacia podalyriifolia/ fimbriata</i>	Silver/ Brisbane wattle
<i>Persoonia iogyna</i>	Tall geebung
<i>Petalostigma pubescens</i>	Quinine bush
<i>Banksia aemula</i>	Wallum banksia
<i>Dodonaea triquetra</i>	Forest hop bush

Recommended total tube stock: 1,500
 Screening area - 600m² @ 1 tree/3m² = 200 tubes
 Shrub/ groundcover area - 1,000m² @ 1 plant/m² = 1,000 tubes
 Sedge areas - 100m² @ 3 plants/m² = 300 tubes
 Indicative species suggestions. Placement based on soil and moisture conditions following construction work, under advice of Regeneration Contractor.
 Plantings to be in accordance with the Planting (Landscape) section of the Landscape Infrastructure Manual (LIM).

Planting Plan

Scholars Drive Link Project

Sippy Downs

- Road
 - Local
 - Private
 - Property boundaries
- Rock pitching/ Sedge planting
- Layer
 - Sedge planting
- Shrub/ groundcover planting
- Screening trees
- Shared roadway

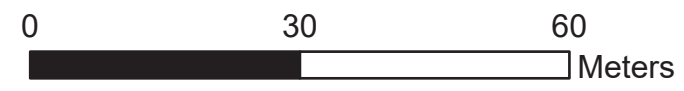

Whilst due care is taken to ensure accuracy, Native Foresters makes no warranty as to the accuracy, completeness or reliability of data or information contained within this product. Appropriate advice should be sought prior to taking any action based on the data or information contained within this product.

Data sources: Qld Government, Sunshine Coast Council, Native Foresters. Date: 21/03/2022 Cartographer: Pru McIntyre. Version: ArcGIS pro.

