



SR2

9 February 2012

SCRC CORRESPONDENCE



B0450575

Mr John Knaggs
Chief Executive Officer
Sunshine Coast Regional Council
Locked Bag 72
Sunshine Coast Mail Centre Qld 4560

Attention: Tennille Balanzategui



Dear Mr Knaggs

Proposed locomotive display

455
26116 R 10 a

**Sunshine Coast Regional Council
Council Application Number: 20273
Mooloolaba Road at the Lindsay Road roundabout**

I refer to your email of 21 December 2011 and to the attached unnumbered drawing with RPEQ Engineering Certification dated 16 December 2011.

The drawings are acceptable to the Department of Transport and Main Roads and the project may proceed to the next phase subject to the following conditions being met:

1. The works must be constructed in accordance with the attached *Standard Conditions for Minor Works within State-controlled Road Boundaries* (Form DC02S05).
2. If the works are to be constructed by a party other than a state or local authority, the following documents must be forwarded to this office prior to the prestart meeting:
 - The attached *Deed of Indemnity* completed and signed on behalf of the party undertaking the works.
 - A current *Certificate of Insurance* which provides evidence of a public liability insurance policy for not less than \$10 million in the name of the party undertaking the works, noting the **State of Queensland, acting through the Queensland Department of Transport and Main Roads** as interested party.

Department of Transport and Main Roads
Program Delivery & Operations / Regions
North Coast Region / Sunshine Coast Office
PO Box 1600
Sunshine Plaza Post Shop Maroochydhore Queensland 4558

Our ref 500/00428(1)-5938 lah12_010
Your ref 20273
Enquiries Mr Les Hudson sym
Telephone +61 7 5370 5555
Facsimile +61 7 5370 5598
Website www.tmr.qld.gov.au
Email sunshinecoast.office@tmr.qld.gov.au

3. This letter does not provide an approval to commence work. A prestart meeting will be required. The department's contact to arrange the prestart meeting, and during the construction phase of the project, is Mr Con Modolo, phone 5370 5555.
4. Work within the state-controlled road boundaries must not commence until the prestart meeting has been held and the department has issued an *Approval to Commence Work*.

This advice is valid for two years from the date of this letter. If the works have not been completed within this two year period the application must be resubmitted for reassessment.

If you require further information about this response, please contact Mr Les Hudson.

Yours sincerely



for S C Duncan
A/Manager (Network Planning & Performance)

Enc (2)



DEED OF INDEMNITY
Property Access/Minor Works

The Regional Director
 Department of Transport and Main Roads
 PO Box 1600
 Sunshine Plaza Post Shop Maroochydore Qld 4558
Attention: Inspector (Private Works)

Access/Development No:
Reference: 500/00428(1)-5938 lah12_010
Property Description: Mooloolaba Road at the
 Lindsay Road roundabout

DEED OF INDEMNITY

(Insert name and address of private individual/organisation which is giving the indemnity)

its servants and agents ("the Applicant") hereby indemnifies and agrees to keep indemnified the STATE OF QUEENSLAND ("the State"), THE DIRECTOR-GENERAL, DEPARTMENT OF TRANSPORT AND MAIN ROADS ("the Director-General"), their servants and agents:

- (a) any proceedings brought against,
- (b) any claim made upon, and
- (c) any loss or costs incurred by

the State of Queensland, the Director-General, their servants and agents in respect of:

- loss of life,
- personal injury, or
- damage to any person or property

as a result of incidents arising out of the construction of locomotive display works ("the works") and occurring during the period of construction of the works.

For use by individual applicants:

SIGNED, SEALED and DELIVERED)
 by _____)
 this _____ day of _____)
 _____ 20 _____)
 in the presence of _____)

Contractors Details
 Name: _____
 Address: _____

 Telephone: _____

(A Witness)

For use by corporate applicants:

THE COMMON SEAL of _____)
 was affixed this _____ day of _____)
 _____ 20 _____)
 by _____)
 a Director and _____)
 a Secretary in the presence of _____)

Public Liability Insurance
 Policy No: _____
 Insurer: _____
 Value: _____
 Expiry Date: _____

Proposed Date of
 Construction Commencement: _____

(A Justice of the Peace)



TRANSPORT PLANNING

The image shows the cover of a document. It has a dark grey background with a white rectangular box in the center. Inside the white box, the title "STANDARD CONDITIONS FOR MINOR WORKS WITHIN STATE-CONTROLLED ROAD BOUNDARIES" is written in bold, black, uppercase letters, centered on four lines.

**STANDARD CONDITIONS FOR
MINOR WORKS
WITHIN
STATE-CONTROLLED ROAD
BOUNDARIES**

STANDARD CONDITIONS FOR MINOR WORKS
WITHIN STATE-CONTROLLED ROAD BOUNDARIES

1. General

The following conditions shall apply to all minor works approved by the District Director (North Coast-Hinterland) [hereinafter referred to as the District Director] for construction within the State-controlled Road.

2. Approval to Commence Work

2.1. No work within the State-controlled road shall commence until:

- (a) the Applicant has submitted the attached Form DC01F02 Deed of Indemnity duly completed and signed,
- (b) a copy of a preconstruction road safety audit carried out by an appropriately qualified person, if required
- (c) the District Director has issued an Approval to Commence Work.

2.2. Approval to commence work by the district Director shall not be interpreted as approval by the Local Government or any other Government Department or Service Authority. The Applicant is responsible for obtaining these approvals, where applicable, prior to the commencement of works. Any conflicting conditions imposed by other Authorities which necessitate amendments are to be brought to the attention of the District Director.

3. Costs

Unless approved otherwise by the District Director the Applicant will be responsible for the full costs of the works, including, traffic control and future maintenance and repairs.

4. Contractor

The work shall be carried out by a contractor approved by the District Director.

5. Standard of Work

5.1 All work within the boundaries of the State-controlled Road shall be carried out in accordance with:

- (a) the approved Plans/Drawings,
- (b) current Main Roads Standard Specifications and Drawings, and
- (c) requirements defined in the letter of approval issued by the District Director.

5.2 Any gravel used shall be crushed rock similar to that defined as Type 2.5 in Main Roads' Standard Specification 11.05. The material shall be placed and compacted in layers of not more than 150mm and shall be free from organic matter.

5.3 Unless otherwise directed by the District Director, the following requirements shall apply to any pipes or drains to be installed:

- (a) Pipes shall be a minimum 375mm diameter, precast concrete pipes conforming to Australian Standard AS4058 and installed in accordance with the manufacturers recommendations.
- (b) Pipes shall be installed so that the invert of the culvert is at the level of the invert of the clean (de-silted) table drain and have a continuous positive longitudinal grade to prevent ponding of water.

5.4 The work shall not cause stormwater to flow across the surface of the road.

5.5 The Applicant shall make good any damage to the existing roadway caused by the construction.

STANDARD CONDITIONS FOR MINOR WORKS
WITHIN STATE-CONTROLLED ROAD BOUNDARIES

6. Traffic

- 6.1 Temporary warning signs and other devices shall be provided by the contractor in accordance with the current Manual of Uniform Traffic Control Devices (Qld).
- 6.2 Additional devices shall be erected as directed by the District Director when required for the safety of road users in a particular location.
- 6.3 No temporary closure of traffic lanes shall be undertaken without the specific prior approval of the District Director.
- 6.4 Once work has commenced, it shall proceed without interruption so as to minimise inconvenience to road users and exposure of the contractor to traffic.
- 6.5 The District Director reserves the right to carry out any works to ensure the safety of road users and recover the cost of the remedial works from the Applicant.

7. Environmental Management

- 7.1 The Contractor/Developer must comply with all environmental legislation including cultural heritage when conducting works within the State-Controlled Road Boundaries;
- 7.2 The Contractor/Developer is required to complete the attached form "Environmental Risk Assessment Checklist" and submit it to the Main Roads' as part of the pre-start documentation;
- 7.3 Removal of vegetation within the State-controlled road reserve;
 - i. During the pre-start meeting the Contractor is to liaise with the Main Roads Works Inspector to reach agreement on the extent of vegetation to be removed;
 - ii. As per Clause 2 (iv) no vegetation clearing shall commence within the State-controlled road reserve without an Approval to Commence Work from the Main Roads works inspector; and
 - iii. Works likely to clear, disturb or affect areas of significant vegetation, or a mangrove habitat, or areas of acid sulphate soils, or potential acid sulphate soils shall not be conducted until appropriate approvals are in place.
- 7.4 The Contractor shall wash down machinery which has recently been used in a known weed infested area before travelling to the Construction site;
- 7.5 The Contractor shall ensure imported top soil is required to be free of contamination and provided in accordance with Main Roads Specification 11.04, 'General Earthworks'. A copy of this specification can be obtained from Main Roads' North Coast Hinterland District Office, phone 5482 0333; and
- 7.6 The Contractor shall immediately notify the Department of Main Roads and the Environmental Protection Agency of incidents which cause or have the potential to cause injury to fauna and/or material or serious environmental harm (as defined in the EP Act).
- 7.7 If cultural heritage is identified, the Contractor/Developer shall ensure work in the immediate area is stopped, contact the Department of Natural Resources, Mines and Water (DNRMW) for advice and inform the Department of Main Roads.

STANDARD CONDITIONS FOR MINOR WORKS
WITHIN STATE-CONTROLLED ROAD BOUNDARIES

8. Workplace Health and Safety Act 1989-1990

For the purpose of this clause the words 'Principal Contractor' and 'serious bodily injury' shall have the meanings ascribed to them under the Workplace Health and Safety Act 1989 - 1990 and the Workplace Health and Safety Regulations 1989 (hereinafter called 'the Act').

The Supervising Engineer shall be responsible for arranging for the appointment of the 'Principal Contractor' under the Act who shall perform all the duties of the 'Principal Contractor' prescribed by the Act, including but not limited to:

- i. giving notice to the Director of Accident Prevention prior to commencing notifiable work under the Act;
- ii. payment of the relevant fees under the Act.

The Contractor shall indemnify, and keep indemnified, the State of Queensland, the Director-General and the Local Authority against all liabilities which may be imposed under the Act or which may arise out of enforcement of any section of the Act and the Contractor shall notify the District Director and the Local Authority of every 'serious bodily injury' which occurs on the works with such notice to be given as soon as possible, but not later than twelve (12) hours after such occurrence.

9. Certificate of Completion

7.1 On completion of the works, the Applicant is to submit to the District Director, a Form PW02S02 certifying that the works have been completed in accordance with the District Director's approval.

A blank Form PW02S02 Certificate of Completion will be supplied with the District Director's Approval to Commence Work.

7.2 On receipt of the duly signed Form PW02S02 Certificate of Completion, the District Director's delegated representative will inspect the works and notify the applicant of any defects requiring rectification.

7.3 The District Director reserves the right to carry out any additional works necessary to ensure the:
(a) integrity of the road pavement, or
(b) ongoing ability to effectively maintain the road, shoulders, drains, or roadside furniture.

10. Acceptance

On completion of the works to the satisfaction of the District Director, a Certificate of Acceptance will be issued by the District Director to the Applicant and a copy forwarded to the Local Government.



20 December 2011

Project No. 110406

Ms Amanda Wiggs
Sunshine Coast Regional Council
Locked Bag 72
Sunshine Coast Mail Centre Qld 4560

Subject: Traffic Engineering Certification Statement,
Project 20273 – Krauss Locomotive Display

Dear Ms Wiggs,

I have reviewed the "Sweep Path Plan" ver. B dated 30/11/11 provided to me by Council.

This plan shows the location of the locomotive display set back from the existing roadway on the corner of Burnett Street (Buderim - Mooloolaba Road) and Lyndsay Road intersection in Buderim.

I have assessed the minimum sight distance requirements for this situation in accordance with the Road Planning and Design Manual and the Austroads Guide to Road Design. On the basis that the 85th percentile approach speed on Buderim - Mooloolaba Road is estimated to be 40 km/h and the required gap acceptance on an arterial should be 5 seconds, the required minimum sight distance is 56m¹.

The proposed locomotive display building is located outside the minimum distance sight triangle in this instance.

I believe that this project will not impact on the safety or performance of the road network and in particular the operation of the roundabout intersection with consideration of the following factors:

- The proposed display is to be located outside the minimum sight distance triangle;
- Road cross-section and road geometry will remain unchanged;
- Road drainage is unaffected;
- The display is outside the "clear-zone" required for this speed environment

I certify that this design is adequate in regard to traffic engineering issues in accordance with the Road Planning and Design Manual and the Austroads Guide to Road Design.

Yours Sincerely,

Grahame Ritchie (RPEQ No. 7314)
Director

¹ Reference – Table 3.1 Austroads Guide to Road Design Part 4B
Traffic Impact Assessments • Car Parking & Swept Path Assessments • Traffic Simulation Modelling • Speed Limit Reviews • Road Safety Audits
Intelligent Transport Systems Design • Traffic Management Plan Preparation & Audit • Road Sign Design • Pedestrian Facilities
Ph 07 54768208 • Fax 07 54768717 • PO Box 357 Woombey, Qld 4559 • grahamer@trafflec.com.au • www.trafflec.com.au

20273 - KRAUSS LOCOMOTIVE DISPLAY

CORNER OF BURNETT STREET AND LINDSAY ROAD, BUDERIM

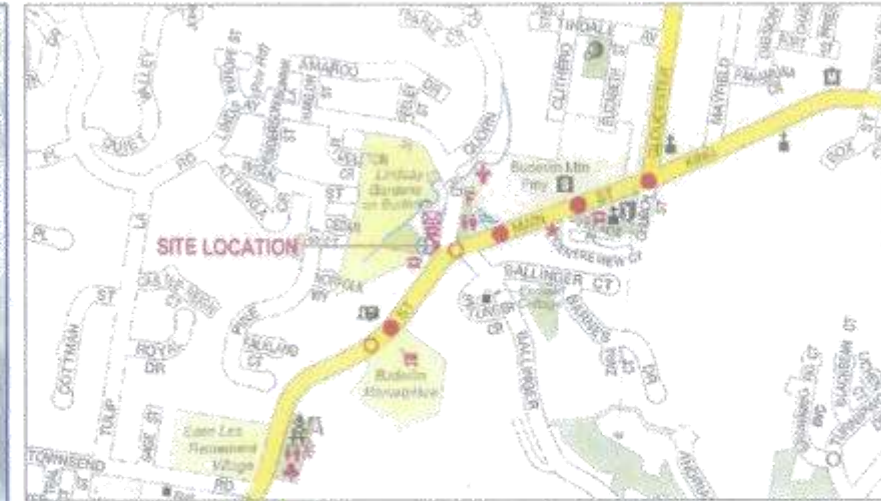
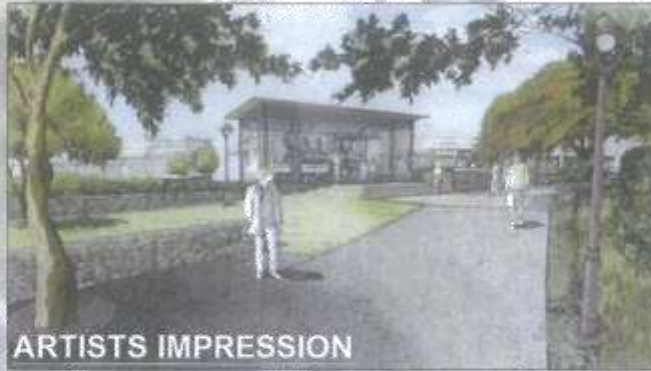
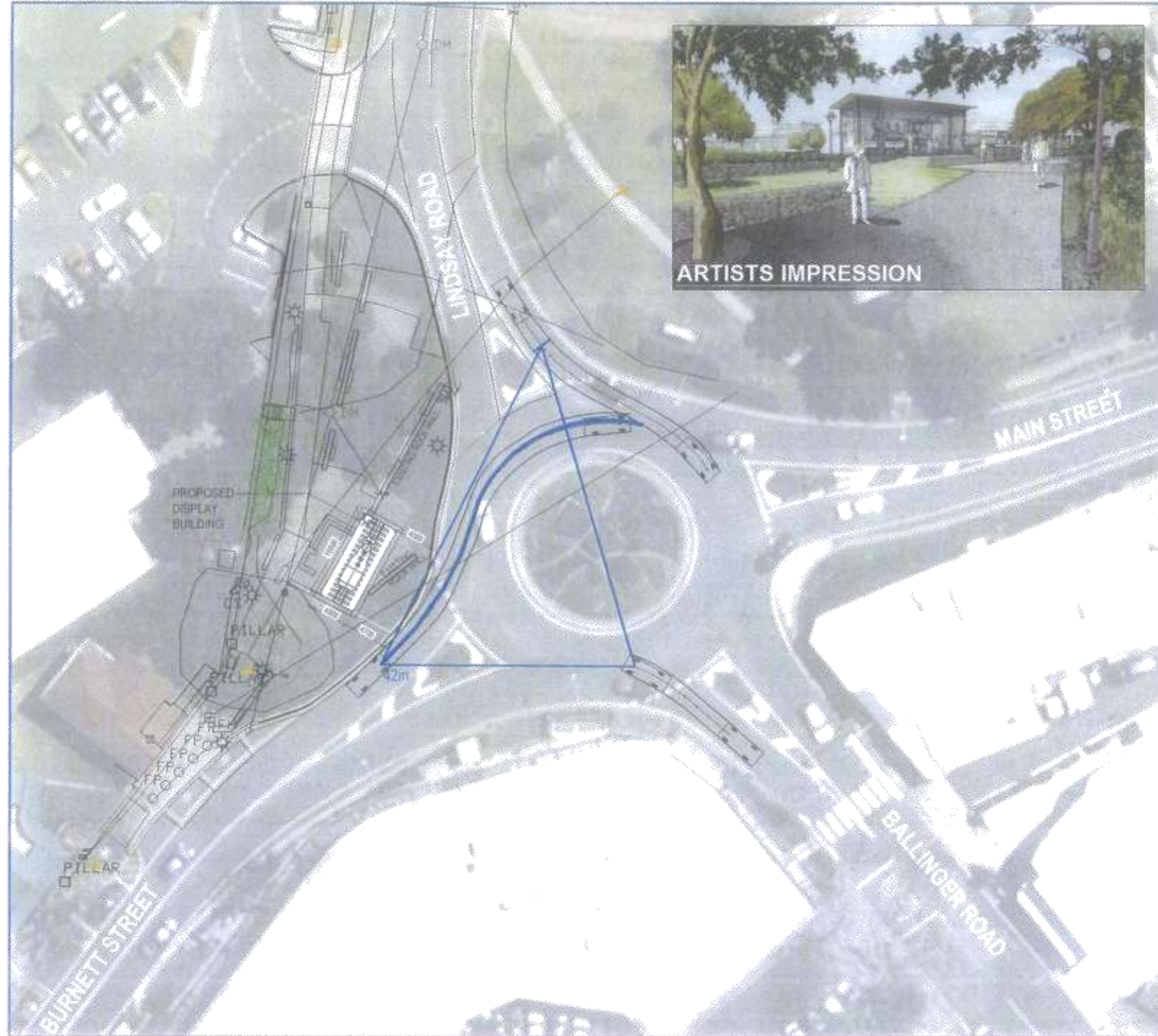

SITE LOCATION

By the signing of this statement I deem to certify all drawings in this contract/project as listed in the drawing index, as being in accordance with the Project Objectives.

PROJECT REVIEW
 NAME: Rhys Pollett TITLE: Team Leader LUD North
 SIGNED: [Signature] DATE: 30 Nov 2011

PROJECT SUBMITTED (Manager)
 I certify that the design meets the requirements of all relevant Council Policies, References, Standards, Planners and Design Instruction, Code of Practice, Guidelines, and Brief/Functional Specifications.
 NAME: Rhys Pollett TITLE: Team Leader LUD North
 SIGNED: [Signature] DATE: 30 Nov 2011

By the signing of this statement I deem to certify all drawings in this contract/project as listed in the drawing index, shown on sheet C001, as being in accordance with the Project Objectives.

PROJECT REVIEW TITLE: _____
 SIGNED: _____ DATE: / / 2011

ENGINEERING CERTIFICATION
 In the effect of Section 115 of the Professional Engineers Act 2002, the professional engineering services in the areas of engineering required for this project have been carried out by or under the supervision of registered professional engineers who are registered under the Act in respect of the areas of engineering. I certify that the design meets the requirements of all relevant Council Policies, References, Standards, Planners and Design Instruction, Code of Practice, Guidelines, DTMR Specifications (applicable to this Project) and Brief/Functional Specifications.

SIGNED: [Signature]
 RPEQ No.: 7314 DATE: 16 / 12 / 2011



SWEEP PATH PLAN

A1				 PSM No. [AHC/PL] SCALE SURVEYED: A1 - 250 DESIGNER: C. DANN CHECKED: R. POLLETT	LANDSCAPE & URBAN DESIGN NORTH PARKS AND GARDENS <small>Member of the the State and Queensland Institute of Landscape Architects 177/178 St. Lawrence Street, Brisbane, QLD 4000 07 3251 4141 Fax Website: www.landscape.com.au</small>	 Sunshine Coast Council	LINDSAY ROAD, BUDERIM KRAUSS LOCOMOTIVE DISPLAY	Project Number
	B	26/11/11	FOR APPROVAL					20273
	A	03/12/10	PRELIMINARY ISSUE					Drawing Sheet No.
	B4	04/11	REVISED					R: B

