

Project number: H3747

Brisbane Road Upgrade

Stages 2 and 3

Mooloolaba Transport Corridor Upgrade



Road and bridge works including day and night works, early morning works, and changes to parking conditions.



Various dates, between Monday 7 November to Wednesday 23 November 2022 (estimated dates only, all works weather and site conditions dependent)



Brisbane Road and Foote Street, Mooloolaba



Traffic control and signage as required

Construction overview

Construction works are continuing for Stages 2 and 3 of the Brisbane Road Upgrade.

With more wet weather forecast over the coming weeks, the construction team is undertaking works in multiple locations simultaneously to progress construction as quickly as possible.

This includes the following day and night works which in some cases, include temporary changes to traffic conditions.

Advance notice is provided for night works to allow residents and businesses to forward plan, including communicating information to other residents, visitors, staff and tenants where possible.

These works have been scheduled to take place after the recent school holiday period and prior to the peak December/January holiday period.

Local bus services will continue to operate with alternative routes and stops in place as required.

Please continue to support all local businesses during construction.

All works are weather dependent and subject to supplier availability.

Works schedule – including temporary changes to traffic conditions

DAY WORKS

Foote Street.

Monday 7 November to Friday 18 November 2022, 6am to 6pm.

Changes to median (island) carparking between Brisbane Road and Burnett Street

As part of the new Foote Street/Brisbane Road/Tarcoola Avenue signalised intersection replacing the roundabout, major underground works including stormwater, electrical and telecommunication upgrades must take place.

To keep Foote Street OPEN and maintain two-way traffic, the central island carparking area between Brisbane Road and Burnett Street will be temporarily removed for use as a traffic lane.

Upon completion of the road works, seven car parking bays will be retained in this area, with seven removed to safely accommodate the new, signalised intersection. (*Refer Figure 1*)

Signage has been in place for some time to provide advance notice to motorists of the temporary and permanent changes to parking conditions.

All information contained in this communication is accurate at the time of distribution however works and dates are subject to change due to circumstances outside of Sunshine Coast Council's control.

Please share this information with your fellow residents, work colleagues and visitors.

Free and metered parking remains available on [nearby streets](#) and at the [ParknGo Mooloolaba Central](#) car park. ParknGo rates are \$2.50 for the first hour and a flat rate of \$5 per day. Monthly passes are also available.

Dates to be advised. Foote Street - full street closure (local traffic only permitted)

In early December (date TBA), Foote Street will be closed to all through traffic for a period of up to five days while the road is resurfaced and line-marked. We will advise local residents and businesses in advance of these works.

NIGHT WORKS

Mayes Canal Bridge, Brisbane Road (northern side of Mayes Canal)

Wednesday 9, 16 and 23 November, 4am – 6am

Concrete pump set up and pouring

As part of the new four lane Mayes Canal bridge large areas of concrete must be formed and poured to support the bridge and bridge approaches.

To keep traffic flowing along Brisbane Road in peak daytime periods, and due to the extent of works and number of concrete trucks required, these works must begin early in the morning.

The early start also ensures the temperature of the concrete remains cool, which in turn assists with pouring, along and curing (drying and strengthening)

While the construction team will try to mitigate noise impacts as much as possible, the nature of these works, combined with the waterside environment means intermittent noise can be expected. (Refer Figure 2)

Access to residences and businesses, waste collection

Access will remain available to residences and business, in some cases under traffic control

Access to Shell Coles Express 24/7 Service Station – remains available

Vehicle and pedestrian access will remain to the service station via Brisbane Road and/or Foote Street, depending on construction activity. Signage is in place to help direct motorists.

Waste collection (general, recycling and green waste) – Foote Street and Brisbane Road

Residents and businesses are advised that waste collection services will continue as normal.

Please place your general, recycling and green waste bins on the street, in your usual location, prior to 6am on the day of your waste service.

Collections will occur between 6.00am and 6.00pm on that day (unless advised otherwise).

Where required, the construction contractor and waste contractors will coordinate relocation and collection of bins when lane closures or detours are in place.

Please collect your empty bins from your usual location and return them to your private property.

Environmental and traffic considerations

All construction is being performed with the relevant Environmental Management Plans and Traffic Management Plans in place.

Motorists are advised to obey reduced speed limits, follow directional signage and the instructions of traffic control and/or Queensland Police.

Detour signage will be erected to communicate traffic changes to motorists and pedestrians.

Please allow extra travel time during construction periods.

Register for project updates and/or contact the project team

To register for construction updates, email your details to mtcu@sunshinecoast.qld.gov.au

For further information, you can contact the project team on 1800 531 597 (during office hours, Monday to Friday 8.30am – 5pm) or email mtcu@sunshinecoast.qld.gov.au



**Figure 1 – Changes to parking conditions and areas of construction, Footo Street
Monday 7 November to Friday 18 November 2022, 6am - 6pm**

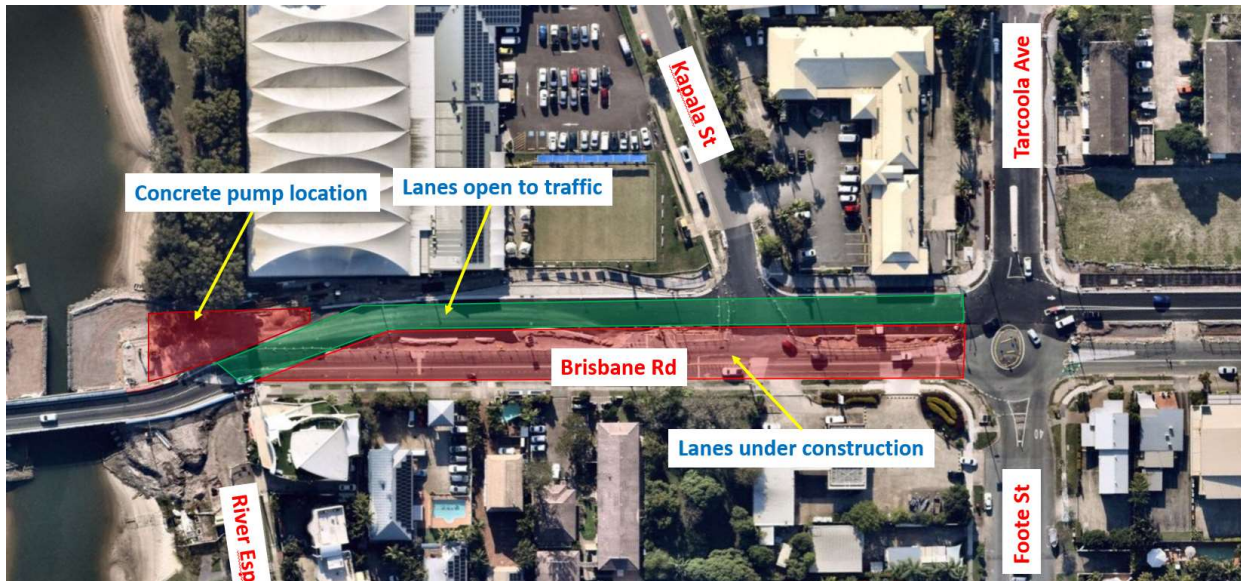

**Figure 2 - Mayes Canal Bridge, Brisbane Road (northern side of Mayes Canal)
Wednesday 9, 16 and 23 November, 4am - 6am**