

 Detail Design Top of Wall
 Existing Top of Wall
 Beach Sprint (indicative)*
 Night Volleyball Court (indicative)*
 *in accordance with permit conditions





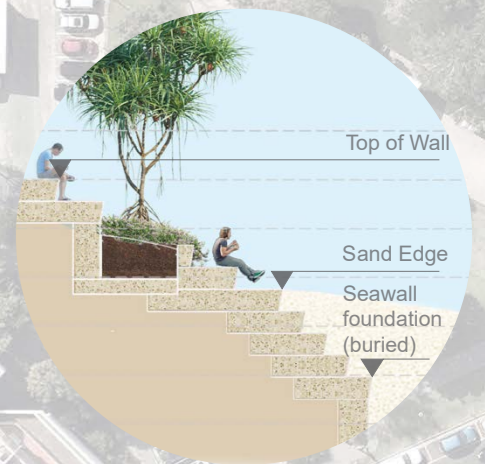
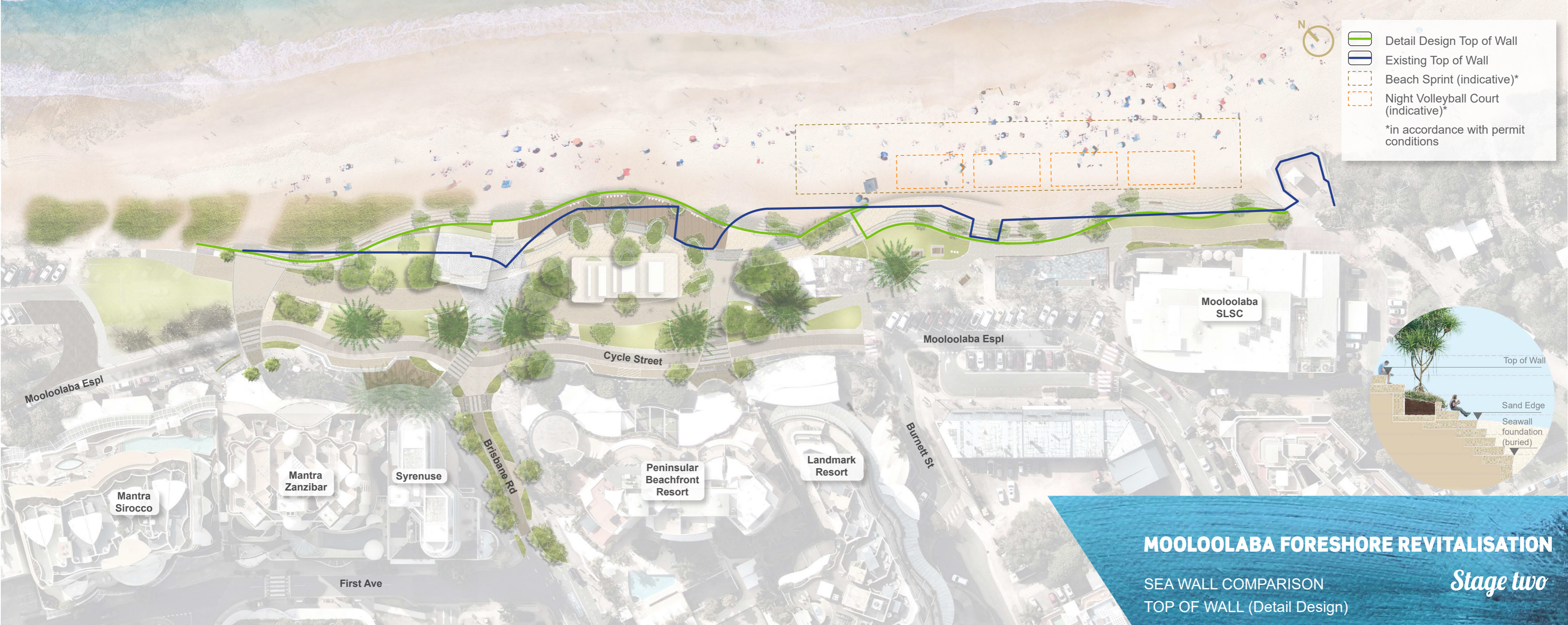

MOOLOOLABA FORESHORE REVITALISATION

SEA WALL COMPARISON
TOP OF WALL (Existing Aerial)

Stage two



-  Detail Design Top of Wall
 -  Existing Top of Wall
 -  Beach Sprint (indicative)*
 -  Night Volleyball Court (indicative)*
- *in accordance with permit conditions

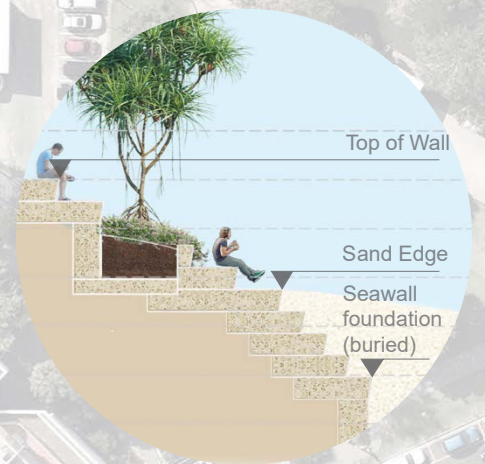

MOOLOOLABA FORESHORE REVITALISATION

SEA WALL COMPARISON
TOP OF WALL (Detail Design)

Stage two

Mooloolaba Espl

Mantra Sirocco

Mantra Zanzibar

Syrenuse

First Ave

Brisbane Rd

Cycle Street

Peninsular Beachfront Resort

Landmark Resort

Burrett St

Mooloolaba Espl

Mooloolaba SLSC

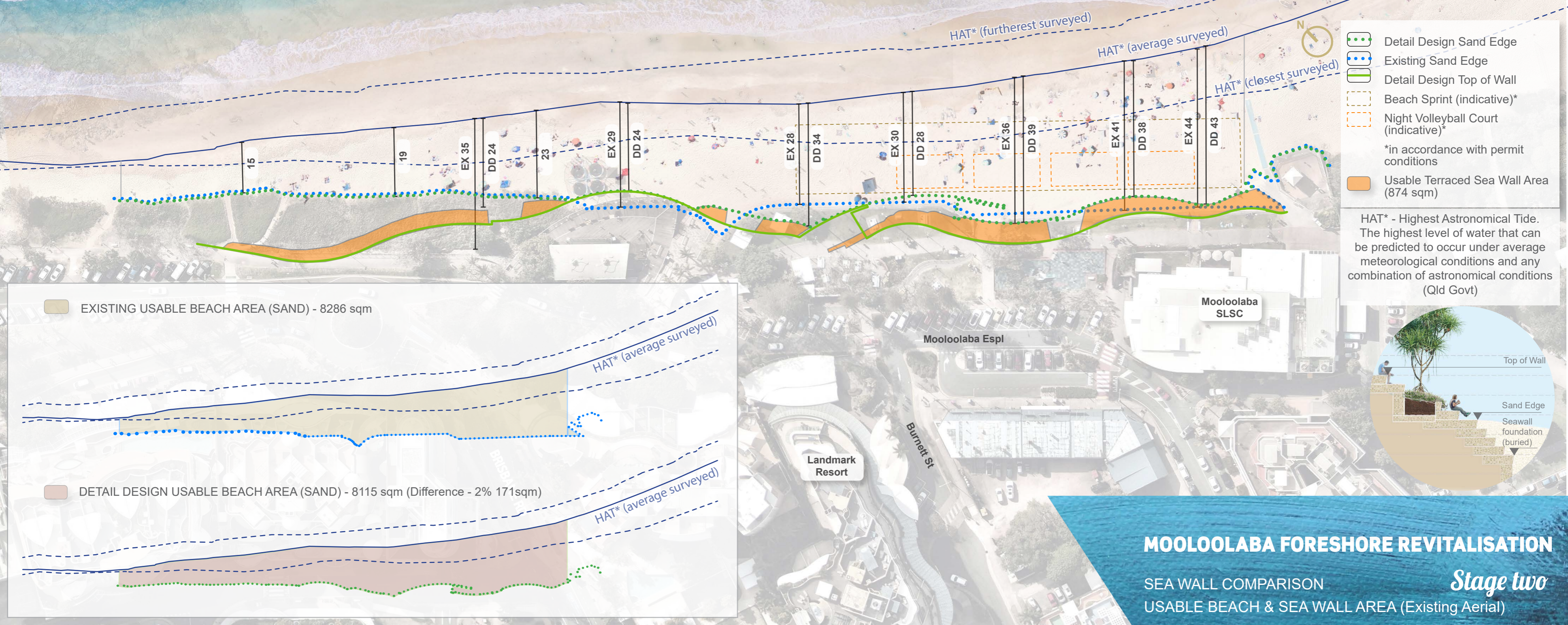

- Detail Design Sand Edge
- Existing Sand Edge
- Detail Design Top of Wall
- Beach Sprint (indicative)*
- Night Volleyball Court (indicative)*
- *in accordance with permit conditions
- Usable Terraced Sea Wall Area (874 sqm)

HAT* - Highest Astronomical Tide. The highest level of water that can be predicted to occur under average meteorological conditions and any combination of astronomical conditions (Qld Govt)

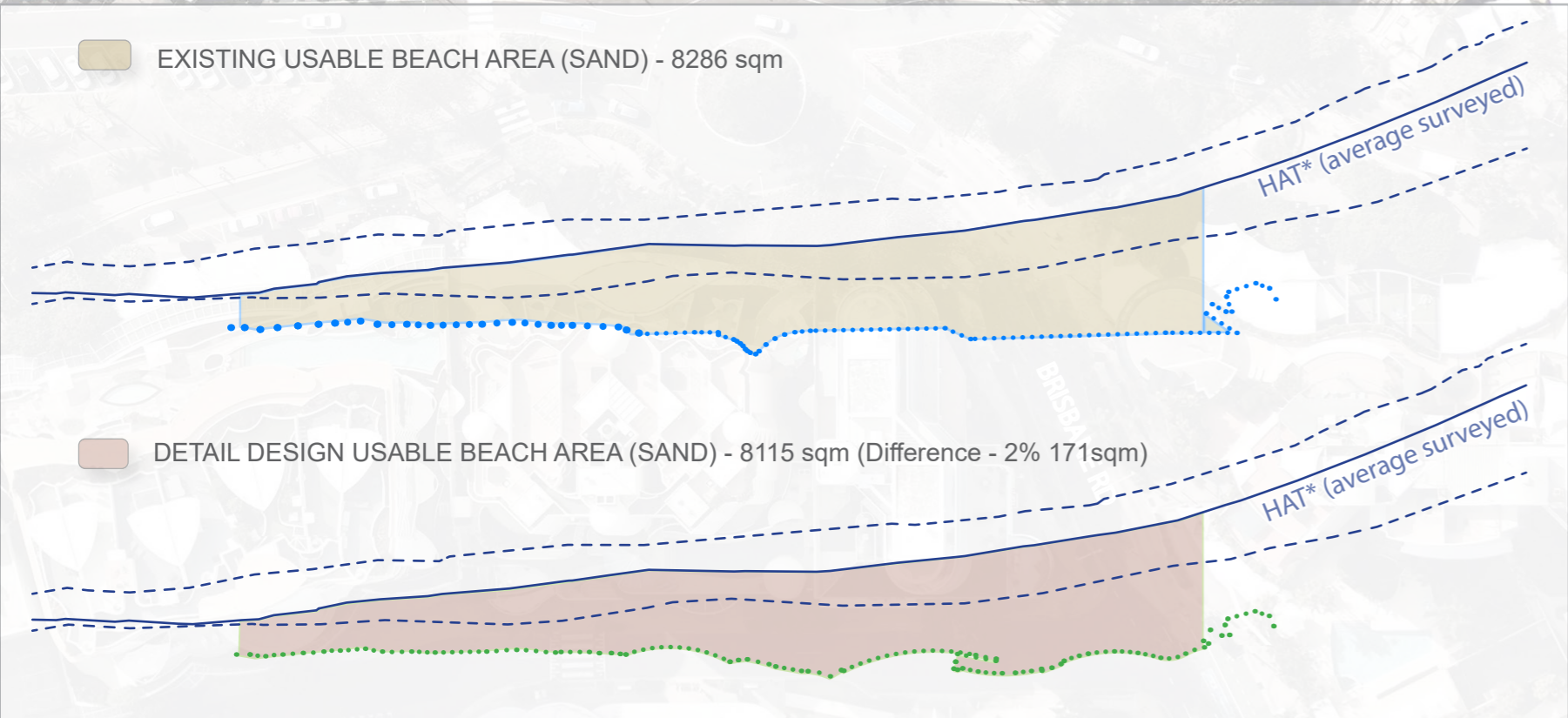
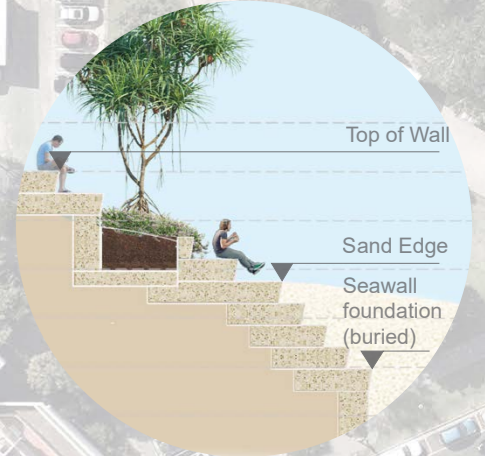

MOOLOOLABA FORESHORE REVITALISATION
 SEA WALL COMPARISON
 USABLE BEACH & SEA WALL AREA (Existing Aerial) *Stage two*

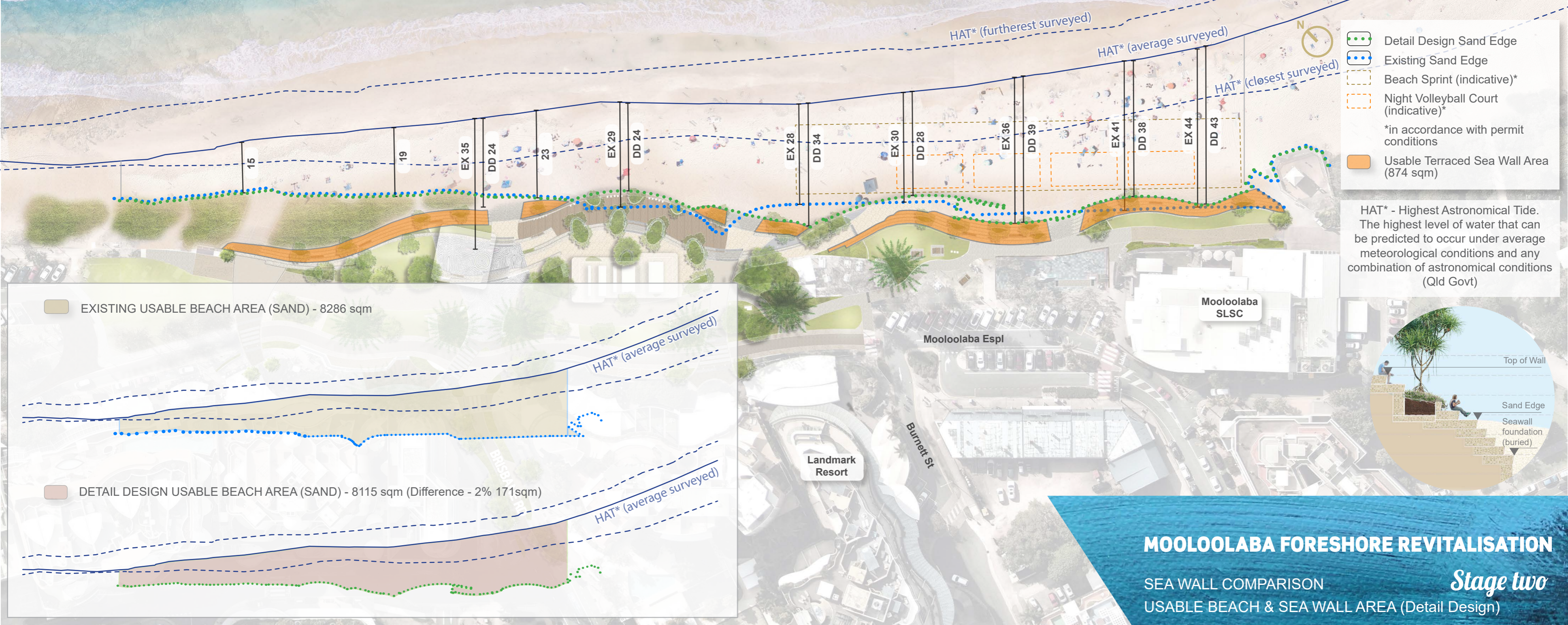

- Detail Design Sand Edge
- Existing Sand Edge
- Beach Sprint (indicative)*
- Night Volleyball Court (indicative)*
- *in accordance with permit conditions
- Usable Terraced Sea Wall Area (874 sqm)

HAT* - Highest Astronomical Tide. The highest level of water that can be predicted to occur under average meteorological conditions and any combination of astronomical conditions (Qld Govt)

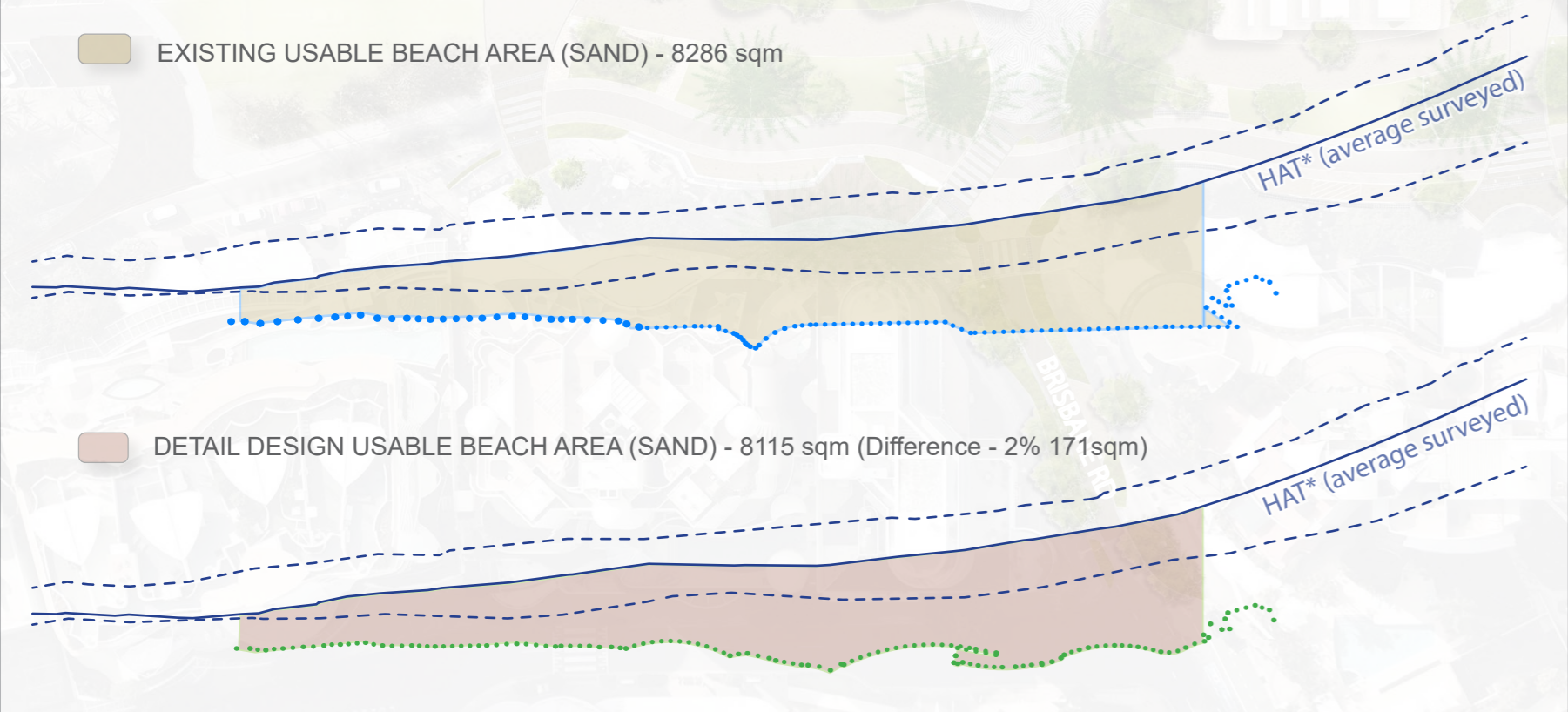
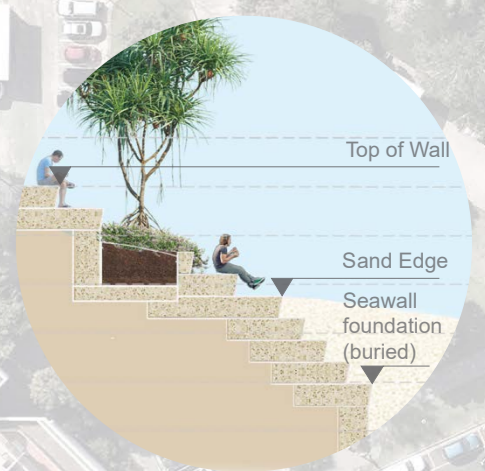

MOOLOOLABA FORESHORE REVITALISATION

SEA WALL COMPARISON

USABLE BEACH & SEA WALL AREA (Detail Design)

Stage two